

# CK□1 Series Related Products

Please contact SMC for detailed dimensions, specifications and lead times.

## 1 CKGA80, 100/CKPA80, 100/With Magnetic Field Resistant Auto Switch (Rod Mounting Type)

Built-in standard magnet type with magnetic field resistant auto switch

Built-in strong magnet type with magnetic field resistant auto switch

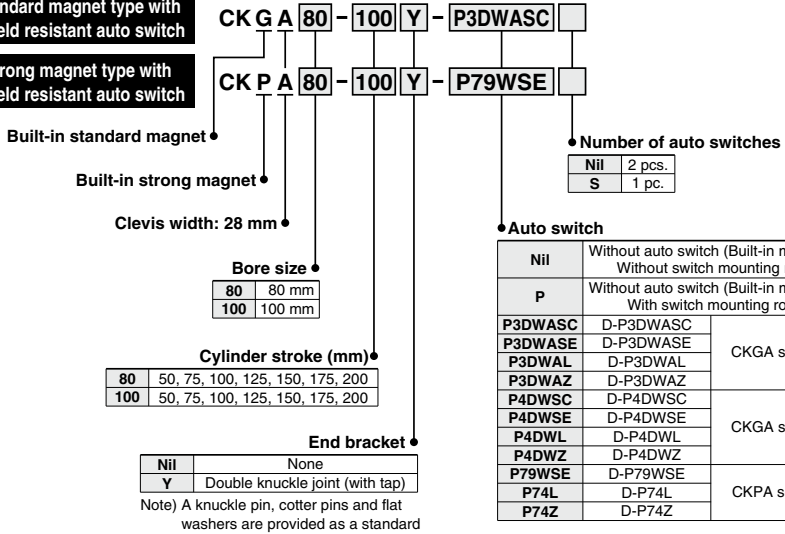

### Specifications

<b>Clevis width</b>	28 mm	CKGA/CKPA series
<b>Fluid</b>	Air	
<b>Proof pressure</b>	1.5 MPa	
<b>Maximum operating pressure</b>	1.0 MPa	
<b>Minimum operating pressure</b>	0.05 MPa	
<b>Ambient and fluid temperature</b>	-10°C to 60°C	
<b>Piston speed</b>	50 to 500 mm/s	
<b>Cushion</b>	With air cushion on both ends	
<b>Speed controller</b>	Equipped on both ends	
<b>Lubrication</b>	Non-lube	
<b>Stroke length tolerance</b>	+ <sub>0</sub> <sup>1.0</sup>	
<b>Mounting</b> <small>(Note)</small>	Double clevis	

Note) A clevis pin, cotter pins and flat washers are provided as a standard.

### Auto Switch Mounting Bracket Assembly/Part No.

Applicable auto switch model	Auto switch mounting bracket part no.	
	80	100
D-P3DWASC	BK7-080S	
D-P3DWASE		
D-P3DWAL		
D-P3DWAZ		
D-P4DWSC	BK9-080	
D-P4DWSE		
D-P4DWL		
D-P4DWZ		
D-P79WSE	BK10-080	
D-P74L		
D-P74Z		

### Built-in Standard (Strong) Magnet Cylinder Part No.

- Built-in standard (strong) magnet type without auto switch, without switch mounting rod  
Symbol for the auto switch type is "Nil" as shown below.  
CKGA: (Example) CKGA80-50Y  
CKPA: (Example) CKPA80-50Y
- Built-in standard (strong) magnet type without auto switch, with switch mounting rod  
Symbol for the auto switch type is "P" as shown below.  
CKGA: (Example) CKGA80-50Y-P  
CKPA: (Example) CKPA80-50Y-P

## 1 CKGA80, 100/CKPA80, 100/With Magnetic Field Resistant Auto Switch (Rod Mounting Type)

### Dimensions

#### CKGA80 Built-in standard magnet type/with magnetic field resistant auto switch (D-P4DWS□)

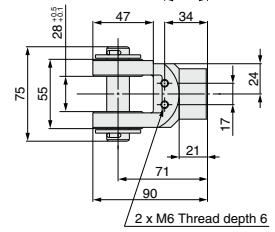
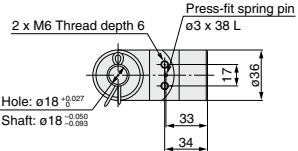
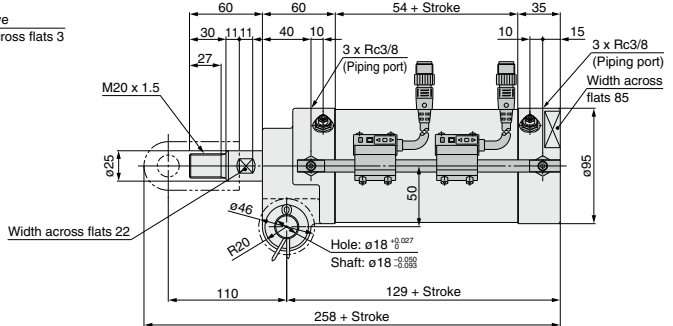
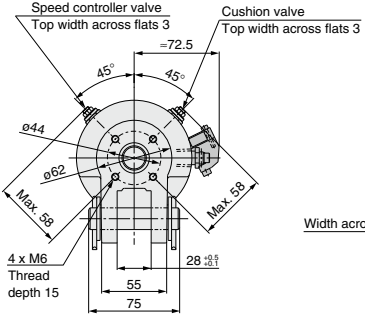

Double knuckle joint

#### CKPA80 Built-in strong magnet type/with magnetic field resistant auto switch (D-P79WSE)

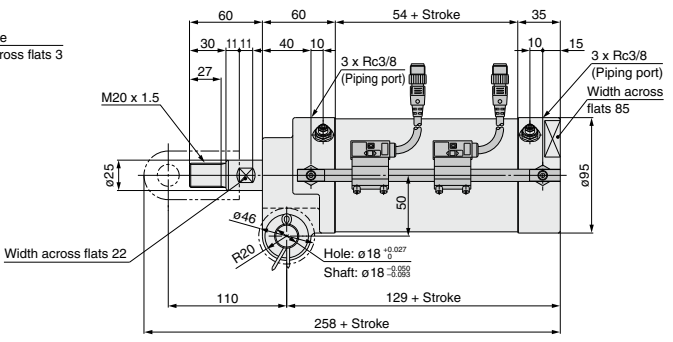
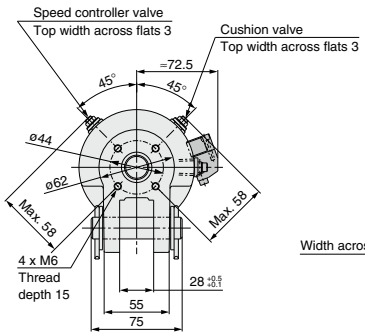

**1** CKGA80, 100/CKPA80, 100/With Magnetic Field Resistant Auto Switch (Rod Mounting Type)

**Dimensions**

**CKGA100 Built-in standard magnet type/with magnetic field resistant auto switch (D-P4DWS□)**

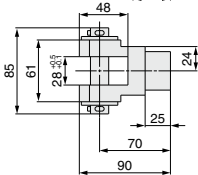
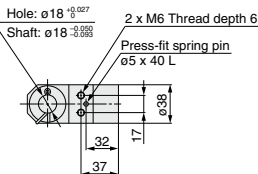
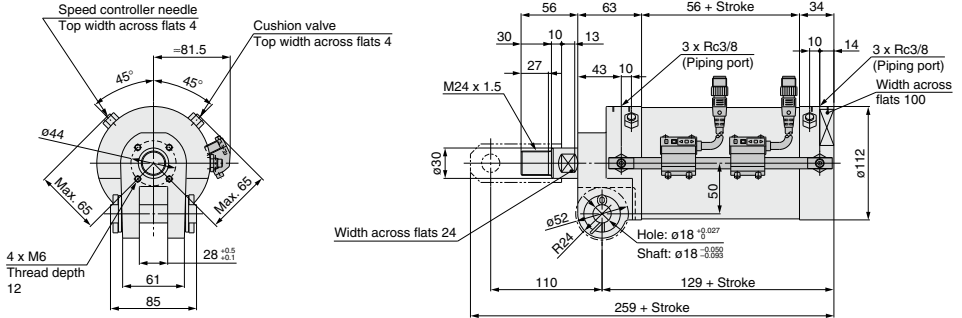

**Double knuckle joint**

**CKPA100 Built-in strong magnet type/with magnetic field resistant auto switch (D-P79WSE)**

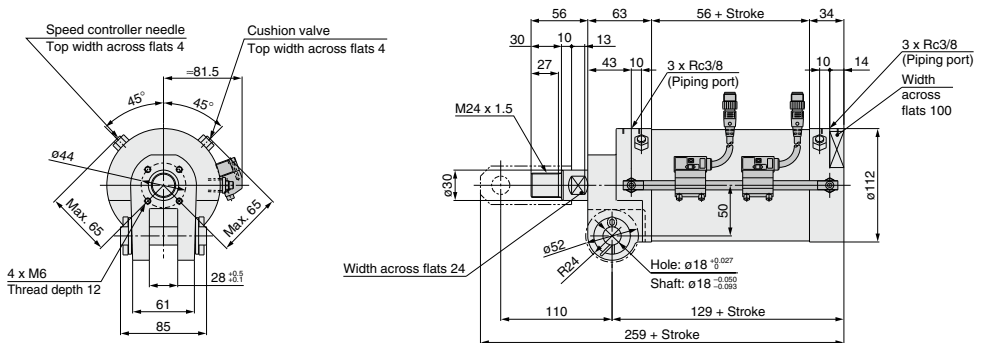

\* Please contact SMC for details of the CKGA□/CKPA□ series.

## 2 CKGA32/With Magnetic Field Resistant Auto Switch D-P4DW□□ (Band Mounting Type)

Band mounting of the magnetic field resistant auto switch (D-P4DW□□) to the built-in standard magnet clamp cylinder (CKGA32 series) is possible by ordering the auto switch mounting bracket and the auto switch separately.

**Built-in standard magnet type with magnetic field resistant auto switch**

**CKGA32-100Y**

- Built-in standard magnet
- Clevis width: 12 mm
- Bore size: 32 mm
- Cylinder stroke (mm)
 

50, 75, 100, 125, 150
-----------------------
- End bracket
 

Nil	None
I	Single knuckle joint (without tap)
Y	Double knuckle joint (without tap)

Note) A knuckle pin, cotter pins and flat washers are provided as a standard for Y.

### Specifications

Clevis width	12 mm	CKGA32 series
Fluid	Air	
Proof pressure	1.5 MPa	
Maximum operating pressure	1.0 MPa	
Minimum operating pressure	0.05 MPa	
Ambient and fluid temperature	-10°C to 60°C	
Piston speed	50 to 500 mm/s	
Cushion	With air cushion on both ends	
Lubrication	Non-lube	
Stroke length tolerance	+1.0 0	
Mounting <sup>Note)</sup>	Double clevis	

Note) A clevis pin, cotter pins and flat washers are provided as a standard.

Applicable auto switch model	Auto switch mounting bracket part no.
D-P4DWSC	BA8-032
D-P4DWSE	
D-P4DWL	
D-P4DWZ	

### Dimensions

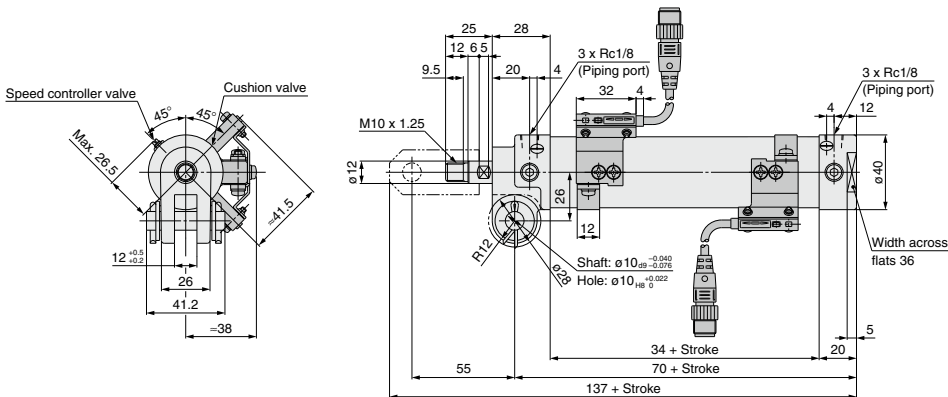

#### Single knuckle joint

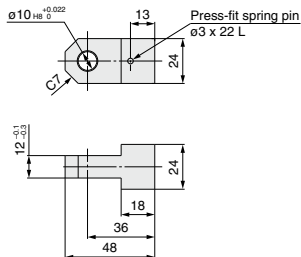

#### Double knuckle joint

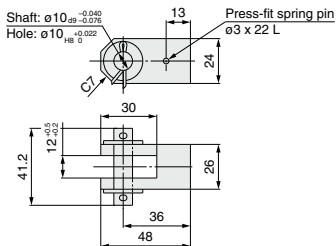

\* Please contact SMC for details of the CKGA32 series.