

Series 10-AS-FG

Stainless Steel Speed Controller with One-touch Fittings (Elbow/Universal type)



How to Order

10 – AS 2 3 1 1 F G – 01 06

Clean series

Body size

1	M5 standard
2	1/8, 1/4 standard
3	3/8 standard
4	1/2 standard

Type

2	Elbow
3	Universal

Control type

0	Meter-out
1	Meter-in

With One-touch fitting

Stainless steel specifications (Stainless steel 303)

Lock nut option

Nil	Hexagon lock nut
J	Round lock nut

Applicable tubing O.D. (Note)

Metric size

23	ø3.2 *
04	ø4
06	ø6
08	ø8
10	ø10
12	ø12

Note) Refer to the following Model list for selection of applicable tubing O.D.
* ø1/8" tubing should be used.

Port size

M5	M5 x 0.8
01	R1/8
02	R1/4
03	R3/8
04	R1/2



Model

Elbow type	Universal type	Port size	Applicable tubing O.D.					
			Metric size					
			3.2	4	6	8	10	12
10-AS12□1FG-M5	10-AS13□1FG-M5	M5 x 0.8	●	●	●			
10-AS22□1FG-01	10-AS23□1FG-01	R1/8	●	●	●	●	●*	
10-AS22□1FG-02	10-AS23□1FG-02	R1/4		●	●	●	●	
10-AS32□1FG-02	10-AS33□1FG-02	R1/4			●	●	●	●
10-AS32□1FG-03	10-AS33□1FG-03	R3/8			●	●	●	●
10-AS42□1FG-04	10-AS43□1FG-04	R1/2					●	●

Note 1) The meter-out and meter-in types can be visually determined by the flow direction symbol on the resin body.

Note 2) * Elbow type only.

Specifications

Proof pressure	1.5 MPa
Max. operating pressure	1 MPa
Min. operating pressure	0.1 MPa
Ambient and fluid temperature	-5 to 60°C (No freezing)
Applicable tubing material	Polyurethane ^{Note 1)}
Grease	Fluorine grease
Cleanliness class (ISO class)	Class 5

Note 1) The maximum operating pressure for polyurethane (at 20 °C) is 0.8 MPa.
(Refer to the **WEB catalog** for details.)

Flow Rate and Sonic Conductance

Model		10-AS12□1FG 10-AS13□1FG	10-AS22□1FG-□01 10-AS23□1FG-□01	10-AS22□1FG-□02 10-AS23□1FG-□02	10-AS32□1FG 10-AS33□1FG	10-AS42□1FG 10-AS43□1FG						
Tubing O.D.	Metric size	ø3.2 ø4 ø6	ø3.2 ø4 ø6 ø8 ø10	ø4 ø6 ø8 ø10	ø6 ø8 ø10 ø12	ø10 ø12						
Controlled flow	Flow rate L/min (ANR)	100	180	230	260	390	460	660	790	920	1580	1710
	Sonic conductance dm ³ /(s·bar)	0.28	0.50	0.64	0.72	1.1	1.3	1.8	2.2	2.6	4.4	4.8
Critical pressure ratio	Controlled flow	0.2	0.25	0.25	0.3	0.3	0.3	0.25	0.25	0.25	0.25	0.25
	Free flow	0.4	0.2	0.2	0.3	0.3	0.3	0.2	0.2	0.2	0.2	0.3

Note) Supply pressure: 0.5 MPa, Temperature: 20°C.

Needle Valve / Flow Rate Characteristics

10-AS12□1FG
10-AS13□1FG

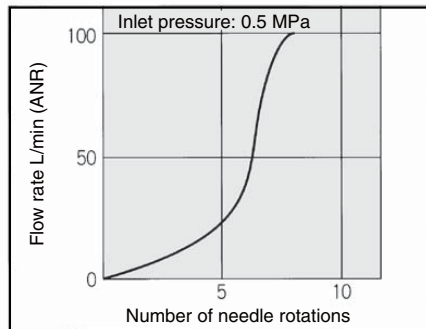

10-AS22□1FG-01
10-AS23□1FG-01

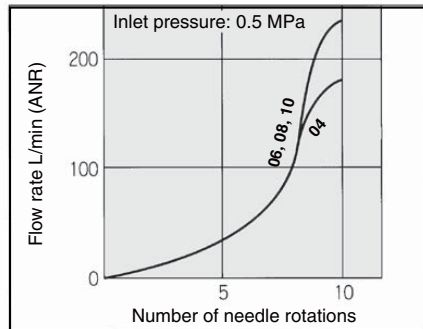

10-AS22□1FG-02
10-AS23□1FG-02

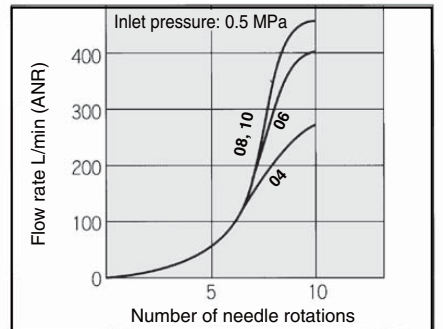

10-AS32□1FG
10-AS33□1FG

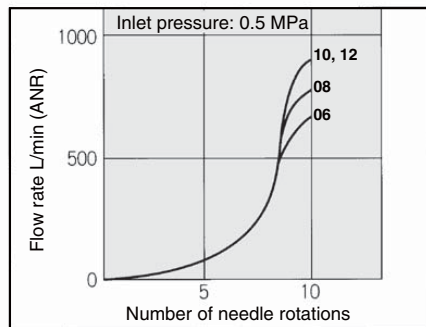

10-AS42□1FG
10-AS43□1FG

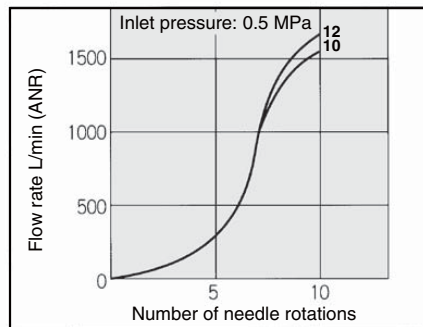

Directional Control Valves

Air Cylinders

Rotary Actuators

Air Grippers

Air Preparation Equipment

Modular F. R.

Pressure Control Equipment

Fittings & Tubing

Flow Control Equipment

Pressure Switches/ Pressure Sensors

Dimensions / Elbow Type

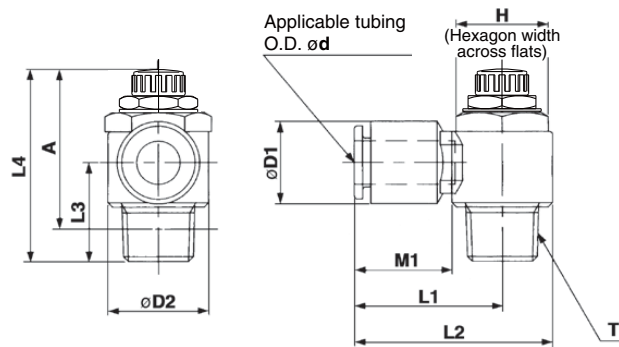

M5 type

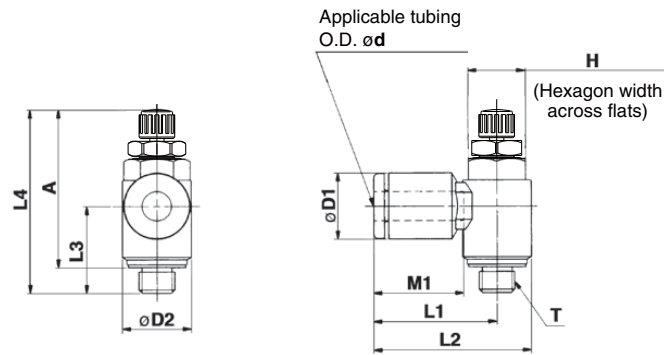

Model	d	T	H	D1	D2	L1	L2	L3	L4		A *		M1	Weight (g)														
									MAX.	MIN.	MAX.	MIN.																
10-AS12□1FG-M5-23	3.2	M5 x 0.8	8	8.4	9.6	17.3	22.1	12.3	28.6	25.8	25	22.2	12.7	7														
10-AS12□1FG-M5-04	4			9.3																								
10-AS12□1FG-M5-06	6			11.6																								
10-AS22□1FG-01-23	3.2	R1/8	12	9.3	14.2	20.4	27.5	14.3	36.1	31.1	32.1	27.1	12.7	16														
10-AS22□1FG-01-04	4			11.6									15.2	25.3	32.4	18.5	21	13.5	17									
10-AS22□1FG-01-06	6																			18.5	40.2	15	18.5	19				
10-AS22□1FG-01-08	8			17		12	10.4	18.5					25.2	34.4	18.2	40.4	35.4	34.4	29.4	13.5	21							
10-AS22□1FG-01-10	10						11.6													15.2	18.5	33.1	40.2	15	21	21		
10-AS22□1FG-02-04	4						12.8						15.2	27.2	36.4					35.3	44.5	20	16	17	18.5	21	16	32
10-AS22□1FG-02-06	6																										12.8	15.2
10-AS22□1FG-02-08	8	19	12	10.4	18.5	27.8	39.3	21.8	48.8	43.8	42.8	37.8	18.5	36														
10-AS22□1FG-02-10	10			12.8									15.2	27.8	39.3	21.8	21	36										
10-AS32□1FG-02-06	6			12.8		15.2	27.8	39.3					27.8	39.3	20.9	48.8	43.8	42.8	37.8	17	60							
10-AS32□1FG-02-08	8																			12.8	15.2	27.8	39.3	20.9	17	63		
10-AS32□1FG-02-10	10																			12.8	15.2	27.8	39.3	20.9	18.5	67		
10-AS32□1FG-02-12	12	19	12	20.9	23	32.8	44.3	20.9	48.8	43.8	42.8	37.8	22	69														
10-AS32□1FG-03-06	6			12.8									15.2	27.8	39.3	27.8	39.3	20.9	17	55								
10-AS32□1FG-03-08	8					12.8	15.2	27.8													39.3	20.9	18.5	57				
10-AS32□1FG-03-10	10			12.8		15.2	27.8	39.3					20.9	21	59													
10-AS32□1FG-03-12	12	R3/8	12	20.9	23	32.8	44.3	20.9	46.5	41.5	40.2	35.2	22	61														
10-AS42□1FG-04-10	10			18.5									20.9	33.6	47.9	25.4	21	100										
10-AS42□1FG-04-12	12					18.5	20.9	33.6											47.9	25.4	22	101						

* Reference thread dimensions after being screwed in.

Dimensions / Universal Type

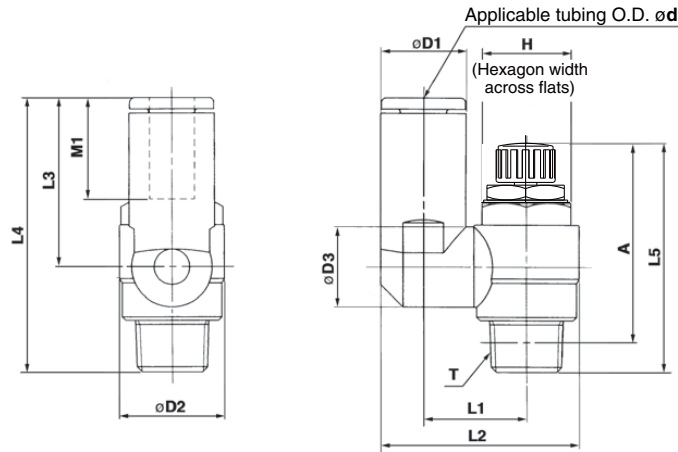

M5 type

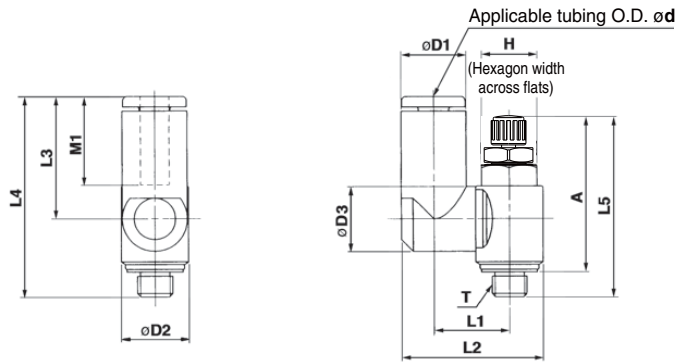

Model	d	T	H	D1	D2	D3	L1	L2	L3	L4	L5		A *		M1	Weight (g)								
											MAX.	MIN.	MAX.	MIN.										
10-AS13□1FG-M5-23	3.2	M5 x 0.8	8	8.4	9.6	9.3	10.8	19.8	17.5	28.7	28.6	25.8	25	22.2	12.7	7								
10-AS13□1FG-M5-04	4			20.3																				
10-AS13□1FG-M5-06	6			21.4																				
10-AS23□1FG-01-23	3.2	R1/8	12	8.4	14.2	10.9	13.1	24.4	17.5	31.8	36.1	31.1	32.1	27.1	12.7	17								
10-AS23□1FG-01-04	4			9.3																				
10-AS23□1FG-01-06	6			11.6																				
10-AS23□1FG-01-08	8			15.2																				
10-AS23□1FG-02-04	4	R1/4	17	10.4	18.5	10.9	16.2	30.6	21.9	40.1	40.4	35.4	34.4	29.4	16	32								
10-AS23□1FG-02-06	6			12.8																				
10-AS23□1FG-02-08	8			15.2																				
10-AS23□1FG-02-10	10			18.5																				
10-AS33□1FG-02-06	6			12.8				20.6	38.5								25.2	47	48.8	43.8	42.8	37.8	17	60
10-AS33□1FG-02-08	8			15.2																				
10-AS33□1FG-02-10	10	18.5																						
10-AS33□1FG-02-12	12	20.9																						
10-AS33□1FG-03-06	6	R3/8	19	12.8	23	12.9	20.6	38.5	25.2	46.1	46.5	41.5	40.2	35.2	17	56								
10-AS33□1FG-03-08	8			15.2																				
10-AS33□1FG-03-10	10			18.5																				
10-AS33□1FG-03-12	12			20.9																				
10-AS43□1FG-04-10	10	R1/2	24	18.5	28.6	16.2	25.8	49.4	32.6	58	57.6	50.1	49.6	42.1	21	104								
10-AS43□1FG-04-12	12			20.9		19.4		26.8									52	36.3	61.7					

* Reference thread dimensions after M5 x 0.8, R thread being screwed in.

Directional Control Valves

Air Cylinders

Rotary Actuators

Air Grippers

Air Preparation Equipment

Modular F. R.

Pressure Control Equipment

Fittings & Tubing

Flow Control Equipment

Pressure Switches/ Pressure Sensors