

# Clean Exhaust Filter Series *SFE*

RoHS

## How to Order



Male thread type



Plug-in type



One-touch fitting type

## SFE 11

### Size/Port size

#### Male thread type

Symbol	Port size	Max. flow capacity L/min (ANR)
11	M5 x 0.8	3
42	R1/8	65
52	R1/8	130
53	R1/4	130
73	R1/4	200

#### Plug-in type

Symbol	Port size	Max. flow capacity L/min (ANR)
3A	ø4	30
4B	ø6	65
5C	ø8	130
7D	ø10	200

#### One-touch fitting type

Symbol	Applicable tubing O.D.	Max. flow capacity L/min (ANR)
3F	ø4	30
4G	ø6	65
5H	ø8	130
7J	ø10	200

### Bracket

## SFE-BR 3

Symbol	Applicable model
3	SFE3□
4	SFE4□
5	SFE5□
7	SFE7□



## Specifications

Model	SFE11	SFE3□	SFE4□	SFE5□	SFE7□	
<b>Fluid</b> <small>Note 1)</small>	Air					
<b>Maximum flow capacity</b> <small>Note 2)</small>	Up to 3 L/min (ANR)	Up to 30 L/min (ANR)	Up to 65 L/min (ANR)	Up to 130 L/min (ANR)	Up to 200 L/min (ANR)	
<b>Filtration rating</b> <small>Note 3)</small>	0.01 μm (Trapping efficiency 99.99%)					
<b>Noise reduction</b> <small>Note 3)</small>	30 dB (A)					
<b>Operating temperature</b>	5 to 45°C					
<b>Differential pressure proof</b> <small>Note 4)</small> (Maximum operating pressure)	0.1 MPa					
<b>Material</b> <small>Note 5)</small>	PBT, Polyolefin, Polyurethane, PP*, Stainless steel*, EPDM (Fluoro coated)*					
	<b>Body</b>	—				
	<b>Gasket</b>	NBR, Stainless steel				
<b>Weight</b>	<b>Male thread</b>	1 g	—	7 g	12 g	17 g
	<b>Plug-in</b>	—	3 g	6 g	11 g	16 g
	<b>One-touch fitting</b>	—	5.5 g	8 g	16 g	24 g
<b>Bracket weight</b>	—	1.2 g	2.5 g	3.5 g	5.5 g	
<b>Applicable tubing material</b> <small>Note 6)</small> (One-touch fitting type)	—	PFA, Polyolefin, Soft polyolefin, Polyurethane				
<b>Replacement period</b>	<ul style="list-style-type: none"> <li>· 2 years or when back pressure reached 0.1 MPa</li> <li>· When the system fails to operate normally due to clogging</li> </ul>					
<b>Packaging</b>	Antistatic double packaging processes					

Note 1) Do not use this product in air containing ozone, since it may break.

Note 2) Model should be selected based on the flow capacity. (Refer to page 2.)

Note 3) Based on SMC's measuring conditions.

Note 4) Pressure applied to SFE, and not supply pressure to the equipment that SFE is mounted to (e.g. solenoid valve, cylinder).

Note 5) The materials with an asterisk (\*) are used for the One-touch fitting type only.

Note 6) Due to the softness of polyurethane tubing, it may fold when being inserted. Hold the end of the tubing and insert it all the way in.

**Dimensions**

**SFE11**

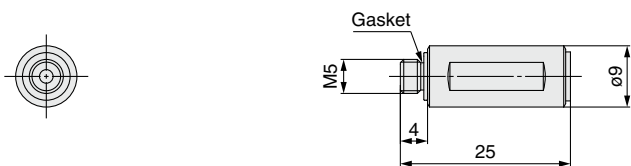

**SFE42/52/53/73**

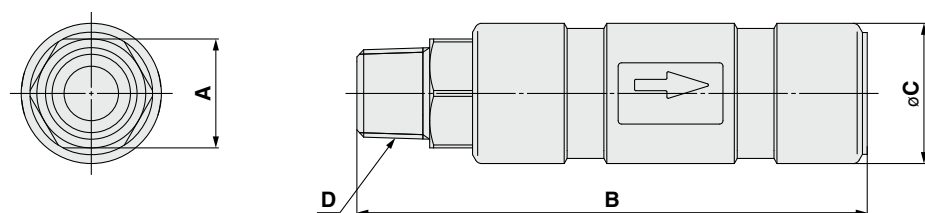

**Dimensions** (mm)

Model	A	B	C	D
<b>SFE42</b>	10	62	16.5	R1/8
<b>SFE52</b>	10	71	20.5	R1/8
<b>SFE53</b>	17	75	20.5	R1/4
<b>SFE73</b>	17	84	24	R1/4

**SFE3A**

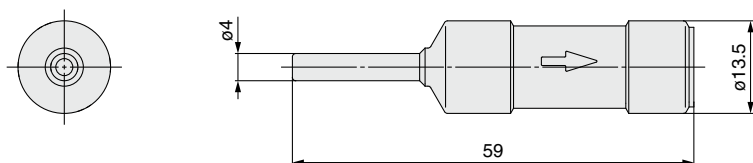

**SFE4B/5C/7D**

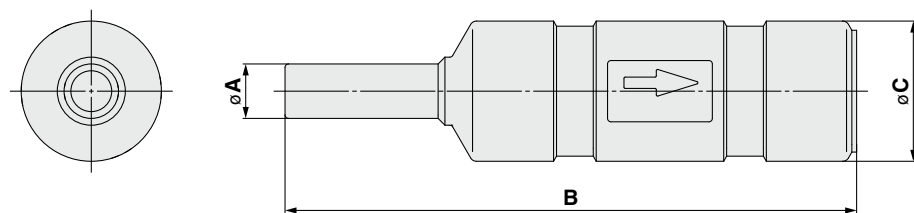

**Dimensions** (mm)

Model	A	B	C
<b>SFE4B</b>	6	73	16.5
<b>SFE5C</b>	8	84	20.5
<b>SFE7D</b>	10	94	24

# Series SFE

## Dimensions

### SFE3F

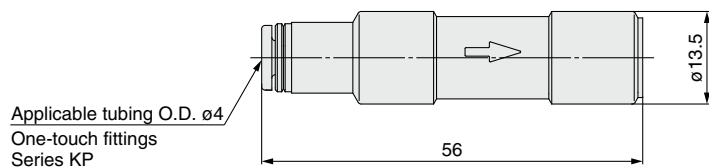

### SFE4G/5H/7J

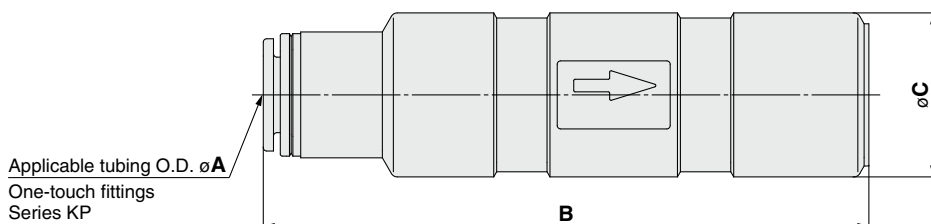

Dimensions (mm)			
Model	A	B	C
SFE4G	6	68.5	16.5
SFE5H	8	79	20.5
SFE7J	10	89	24

## Bracket

### SFE-BR3



### SFE-BR4/5/7

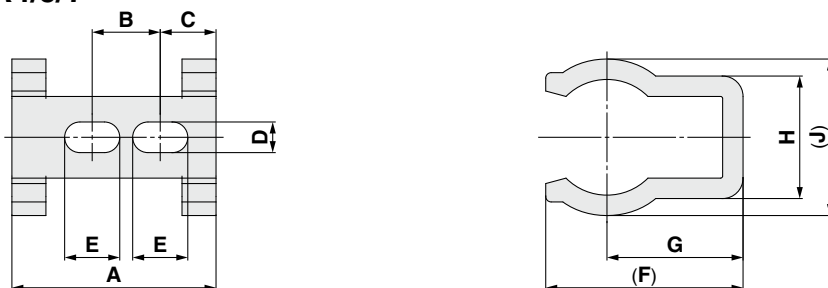

Dimensions (mm)									
Model	A	B	C	D	E	F	G	H	J
SFE-BR4	30	16	7	4.5	7.5	(24.5)	17	15.5	(19.5)
SFE-BR5	30	10	8.2	4.5	8.1	(29)	20	18	(23)
SFE-BR7	34	14	7.35	4.5	9.8	(35)	24	20	(27.3)

( ): Reference dimensions