

Frame Clamp Cylinder WRF100

How to Order



WRF100-**T200** **C**

• Protective cover

Nil	Without cover
C	With cover

• Clamp arm

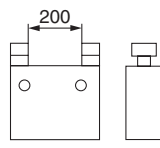
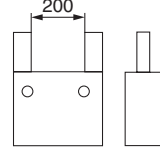
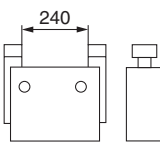
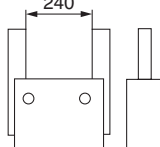
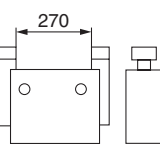
Symbol	T-type arms	Symbol	S-type arms
T200		S200	
T240		S240	
T270		—	—

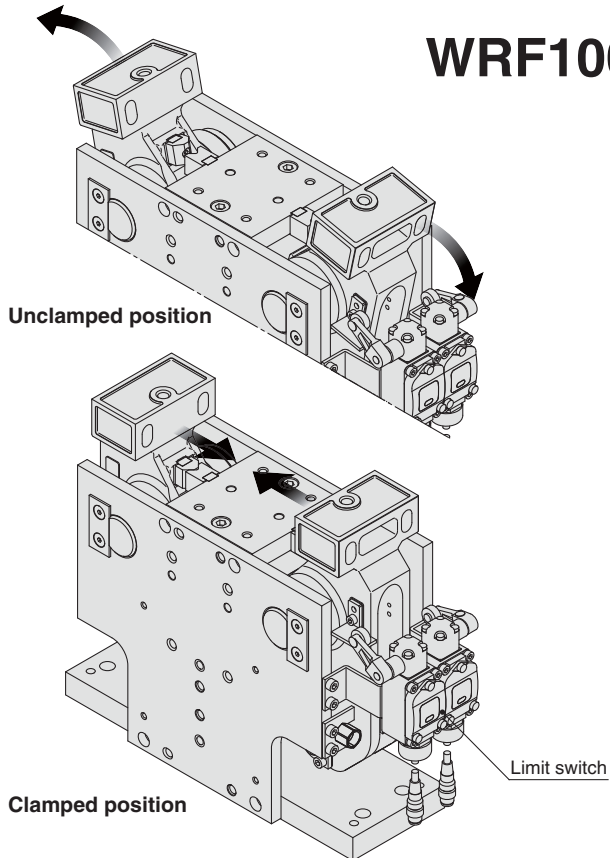

Note) This product does not include the limit switch.

(The limit switch should be prepared by the customer.)

Applicable limit switches have part numbers listed on the right.

For mounting the limit switch, order the switch mounting bracket (WRF-BK) separately.

For details, refer to page 86.

<Applicable limit switches for part number>

OMRON Corp.: WLG2-LDAS-DGJS03T

Azbil Corp.: 1LS74-JWC-P025

Specifications

Bore size	100 mm
Stroke	48 mm
Fluid	Air
Proof pressure	0.8 MPa
Maximum operating pressure	0.5 MPa
Minimum operating pressure	0.2 MPa
Ambient and fluid temperature	-10 to 60°C (No freezing)
Cushion	Clamp side : None Unclamp side: Rubber bumper
Lubrication	Non-lube
Operating time	1.0 s or more (Both clamp and unclamp)
Arm opening angle	24° (12° each side)
Clamping force	20,000 N or more (At 0.5 MPa) ^{Note)}
Weight	47 kg (WRF100-T200)
	47 kg (WRF100-S200)

Note) For the position where the clamping force is generated, refer to the dimensions on pages 82 to 84.

Dimensions

WRF-T□/T-type clamp arms (Without cover)

WRF100-T200/T240/T270

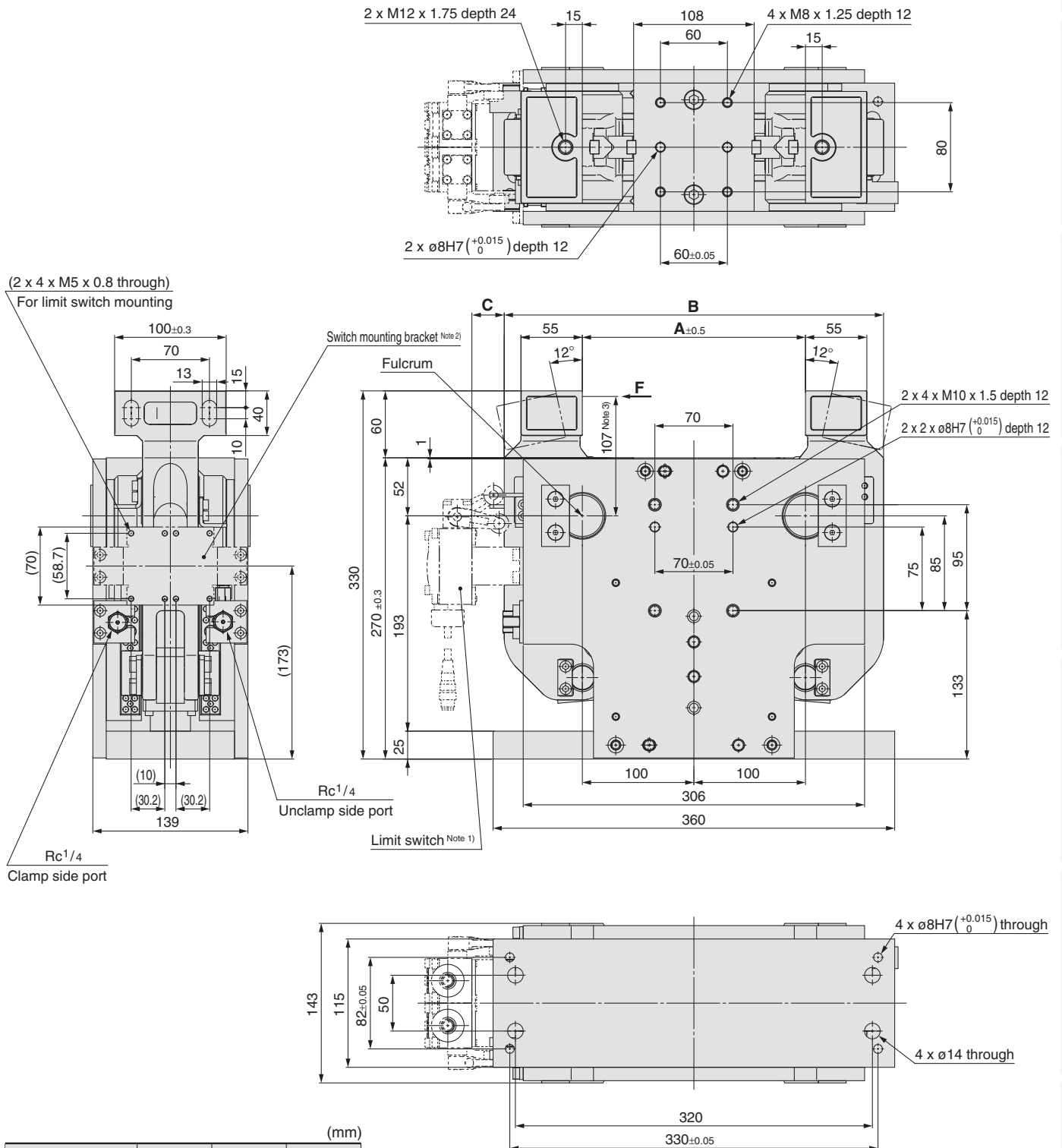

Arm type	A	B	C
T200	200	340	29
T240	240	360	19
T270	270	380	9

Note 1) This product does not include the limit switch.

Note 2) For mounting the limit switch, order the switch mounting bracket (WRF-BK) separately. For details, refer to page 86.

Note 3) The symbol F in the dimensions indicates the position where the clamping force is generated defined by the product specifications.

WRF100

Dimensions

WRF-S□/S-type clamp arms (Without cover)

WRF100-S200/S240

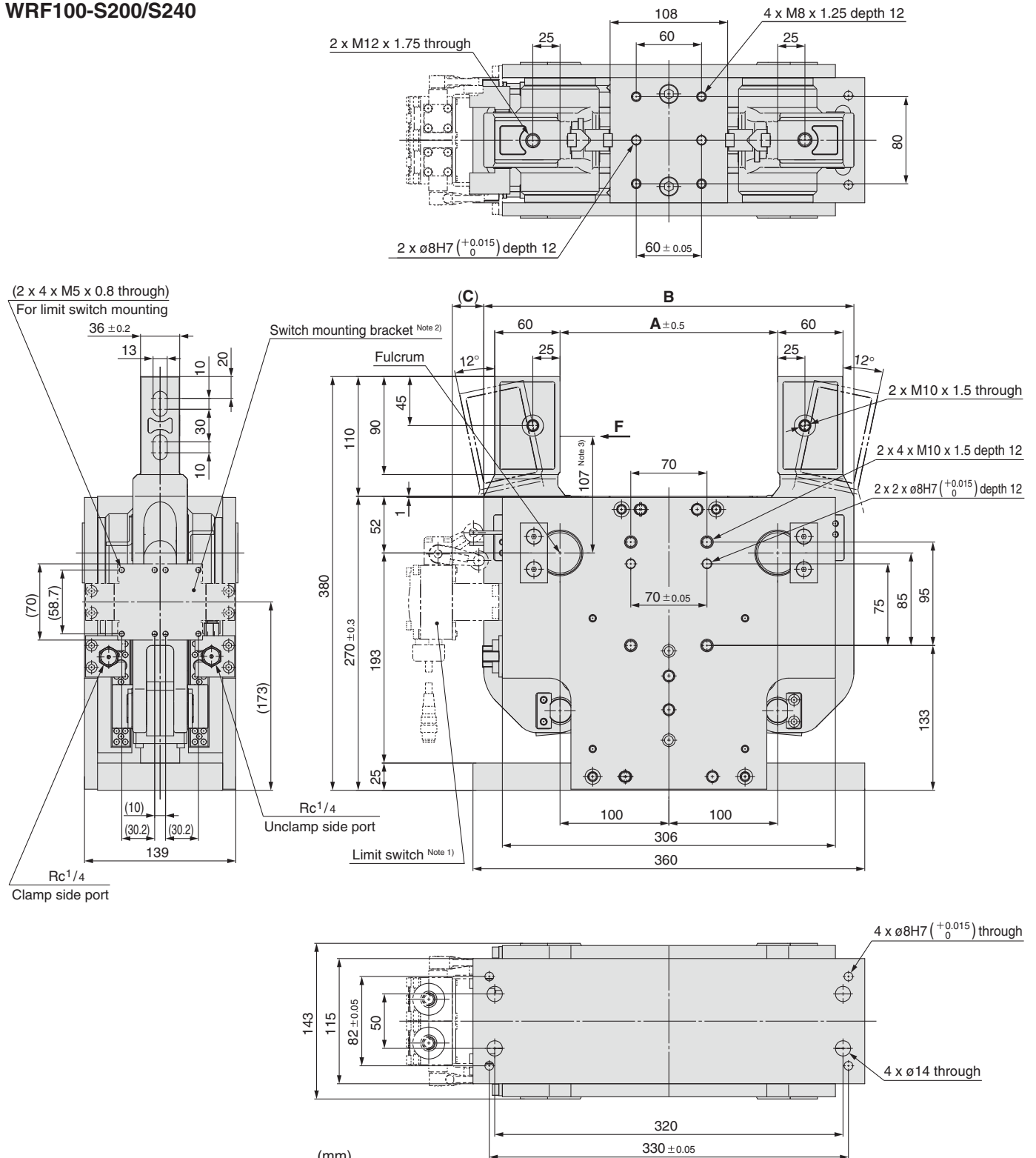

Arm type	A	B	C
S200	200	340	29
S240	240	360	19

Note 1) This product does not include the limit switch.

Note 2) For mounting the limit switch, order the switch mounting bracket (WRF-BK) separately. For details, refer to page 86.

Note 3) The symbol F in the dimensions indicates the position where the clamping force is generated defined by the product specifications.

WRF100



Dimensions

WRF-T□C/With protective cover

WRF100-T200C

Note) Protective cover dimensions shown in the figures are the same even if arm types are different.

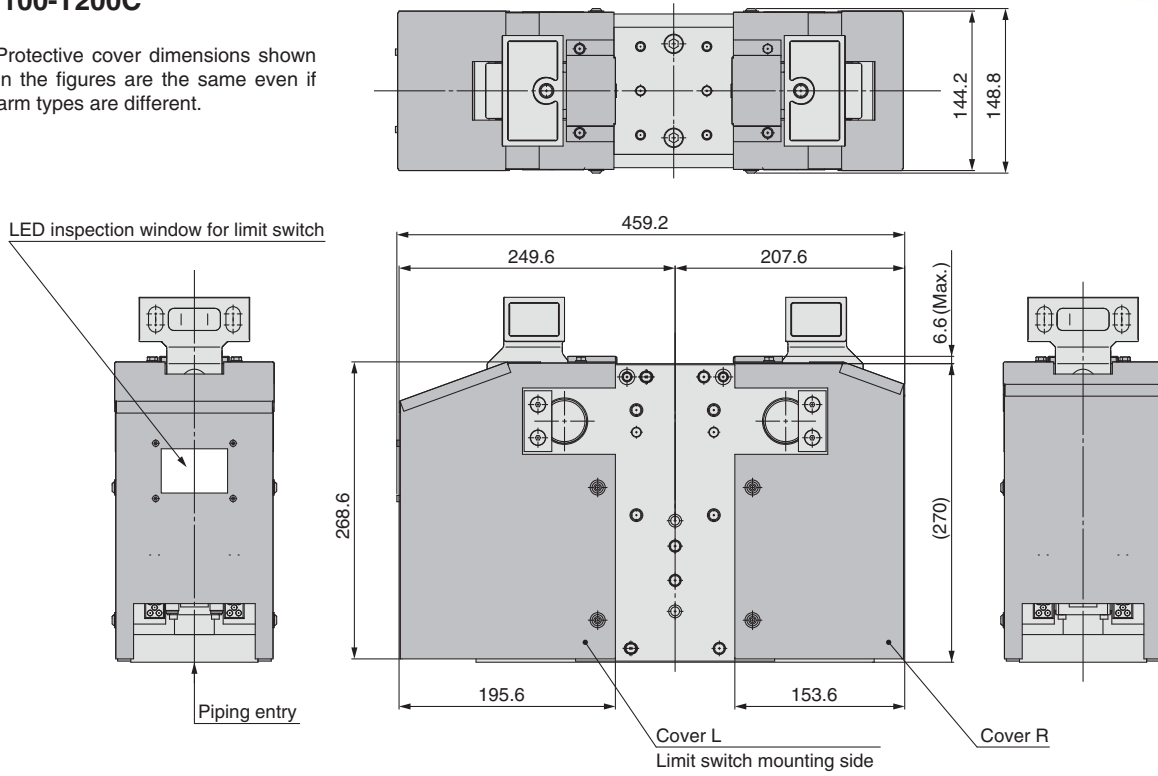

Protective Cover Kit (Option)

A protective cover can be retrofitted.

Fixing method for protective covers

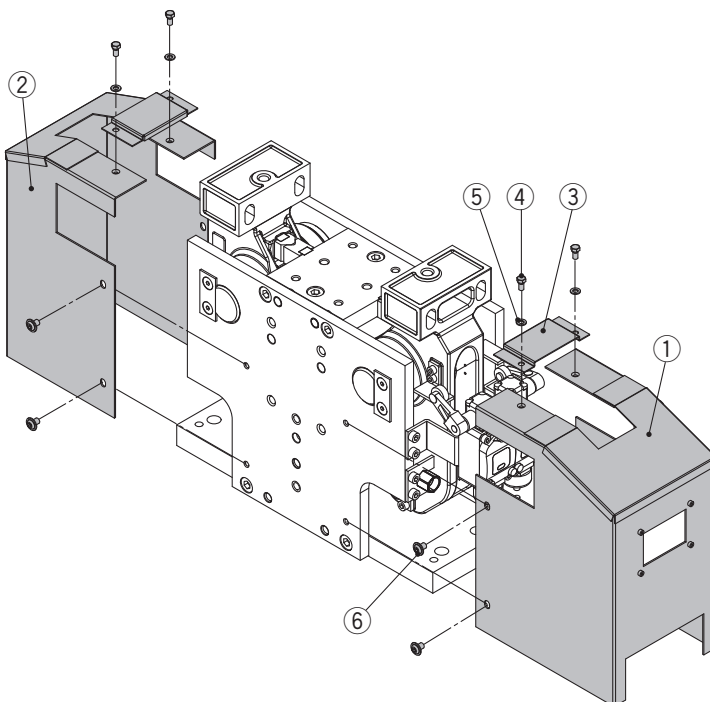

Applicable product	Kit no.	Contents
WRF100-T200	WRF-C200	① Cover L (1 pc.)
WRF100-S200		② Cover R (1 pc.)
WRF100-T240	WRF-C240	③ Top covers (2 pcs.)
WRF100-S240		④ Hexagon head bolts (4 pcs.)
WRF100-T270	WRF-C270	⑤ Flat washers (4 pcs.)
		⑥ Cover mounting bolts (8 pcs.)

Tightening torque for cover mounting bolts

Location	Tightening torque (N·m)
④	3.0 to 4.0
⑥	5.0 to 7.0

<Mounting procedure>

1. Mount the cover L (①) and cover R (②) on the cylinder body.
Mount the cover L (①) on the side where a limit switch is mounted.
2. Mount the top covers (③) to the cover L (①) and cover R (②).

* When mounting the protective cover, confirm that all air has been exhausted from inside the cylinder.

Limit Switch Mounting Bracket (Option)

Bracket for attaching a limit switch

Fixing method for switch mounting brackets

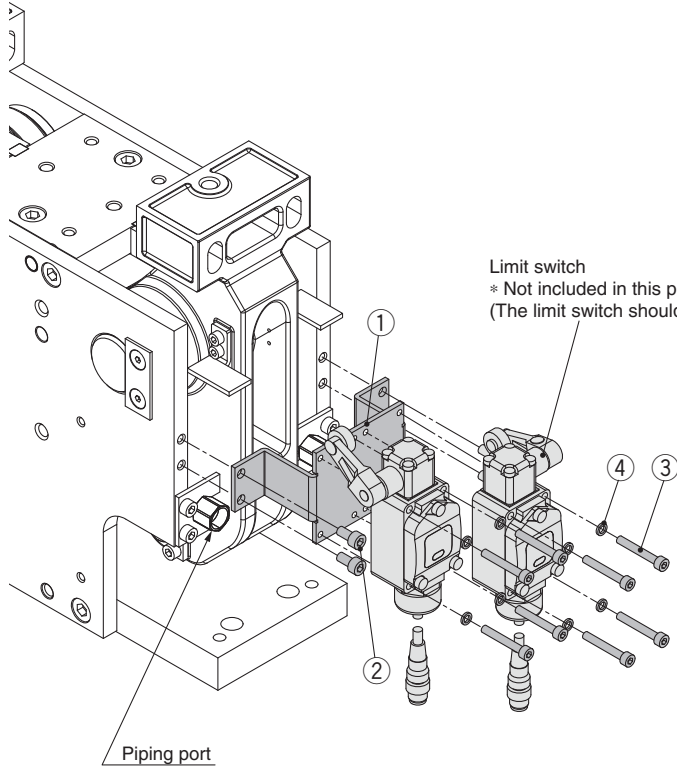

Applicable product	Kit no.	Contents
Applicable to all types	WRF-BK	① Switch mounting bracket (1 pc.) ② Bracket mounting bolts (4 pcs.) ③ Switch mounting bolts (8 pcs.) ④ Flat washers (8 pcs.)

Tightening torque for mounting bolts of switch mounting bracket

Location	Tightening torque (N·m)
②	5.0 to 7.0
③	3.0 to 4.0

Note) This product does not include the limit switch. (The limit switch should be prepared by the customer.)
Applicable limit switches have part numbers listed below.
For mounting the limit switch, order the switch mounting bracket (WRF-BK) separately.

<Applicable limit switches for part number>

OMRON Corp.: WLG2-LDAS-DGJS03T
Azbil Corp.: 1LS74-JWC-P025

- *1 When mounting accessories, confirm that all air has been exhausted from inside the cylinder.
- *2 A limit switch can also be mounted on the side opposite to that with the piping port.