

Blow Gun VMG Series

RoHS



How to Order

VMG 1 1 W - 02 - 32 - C

Piping entry

1	Bottom
2	Top

Body color

W	White
BU	Dark blue

Connection size

Symbol	Piping connection method	Size and model no.
02	Threaded	Rc1/4
03		Rc3/8
N02		NPT1/4
N03		NPT3/8
F02		G1/4
F03		G3/8
11		S coupler
12	plug	KK4P-02MS KK130P-02MS
H06	Metric size One-touch fitting	Model no. of fitting used
H08		KQ2H06-02AS KQ2H08-02AS
H10		KQ2H10-02AS
H07	Inch size One-touch fitting	Model no. of fitting used
H09		KQ2H07-35AS KQ2H09-35AS
H11		KQ2H11-35AS

Note 1) S coupler and fitting are included in the same package.

Note 2) Port size is Rc1/4 if using the S coupler plug.

Note 3) The blow gun port size is Rc1/4 if using the metric size One-touch fitting.

Note 4) The blow gun port size is NPT1/4 if using the inch size One-touch fitting.

With nozzle cover (Only for male thread nozzle, ø6 extension nozzle)

Nil	None
C	With nozzle cover/HNBR
CF	With nozzle cover/Fluororubber

Nozzle

Symbol	Type	Nozzle size	Nozzle part no.
Nil		Without nozzle	
01	Male thread nozzle	ø1	KN-R02-100
02		ø1.5	KN-R02-150
03		ø2	KN-R02-200
04		ø2.5	KN-R02-250
05		ø3	VMG1-R02-300
06		ø3.5	VMG1-R02-350
07		ø4	VMG1-R02-400
11	High efficiency nozzle	ø1	KNH-R02-100
12		ø1.5	KNH-R02-150
13		ø2	KNH-R02-200
21	Low noise nozzle with male thread	ø0.75 x 4	KNS-R02-075-4
22		ø0.9 x 8	KNS-R02-090-8
23		ø1 x 4	KNS-R02-100-4
24		ø1.1 x 8	KNS-R02-110-8

Extension nozzle

Symbol	Type	Nozzle length	Nozzle size	Nozzle part no.
31	ø6 copper extension nozzle (Note)	300 mm	ø1.5	VMG1-06-150-300
32			ø2	VMG1-06-200-300
33		600 mm	ø1.5	VMG1-06-150-600
34			ø2	VMG1-06-200-600
35		100 mm	ø1.5	VMG1-06-150-100
36			ø2	VMG1-06-200-100
37	150 mm	ø1.5	VMG1-06-150-150	
38		ø2	VMG1-06-200-150	
41	ø8 copper extension nozzle (Note)	100 mm	ø2.5	VMG1-08-250-100
42			ø3	VMG1-08-300-100
43			ø3.5	VMG1-08-350-100
44			ø2.5	VMG1-08-250-150
45		150 mm	ø3	VMG1-08-300-150
46			ø3.5	VMG1-08-350-150
47		300 mm	ø2.5	VMG1-08-250-300
48			ø3	VMG1-08-300-300
49			ø3.5	VMG1-08-350-300
50			ø2.5	VMG1-08-250-600
51	600 mm	ø3	VMG1-08-300-600	
52		ø3.5	VMG1-08-350-600	

Note) Part number for set of extension nozzle and fitting. Extension nozzle and fitting are included in the same package.

Refer to "How to attach extension nozzle" in the operation manual for assembly procedures.

Specifications

Fluid	Air	
Operating pressure range	0 to 1.0 MPa	
Proof pressure	1.5 MPa	
Ambient and fluid temperature	-5 to 60°C (No freezing)	
Flow rate characteristics (With nozzle removed)	C (dm ³ /s·bar): 6.0, b: 0.25 (Effective area: 30 mm ²)	
Port size	Rc, NPT, G 1/4, 3/8	
Piping entry	Bottom	Top
Nozzle port size	Rc1/4	
Weight (Main unit only)	165 g	
Operational force (when the valve is fully open)	7 N	

Construction

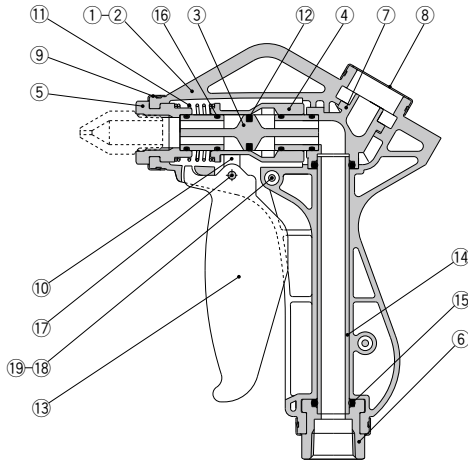

Component Parts

No.	Description	Material	Note
1	Body L	PBT	
2	Body R	PBT	
3	Main valve	PBT	
4	Valve guide	POM	
5	Nozzle holder	Aluminium alloy	Anodized
6	Port	Aluminium alloy	Anodized
7	Elbow	PBT	Only for the VMG12□
8	Cover	Stainless steel	
9	Ring	Stainless steel	
10	Arm	PBT	
11	Spring	Stainless steel	
12	Main valve seal	HNBR	
13	Lever	PBT	
14	Piping (bottom)	POM	Only for the VMG11□ Combined with the elbow (7).
15	O-ring	NBR	
16	O-ring	NBR	
17	Parallel pin	Stainless steel	
18	Cross recessed round head screw	Stainless steel	
19	Hexagon nut	Stainless steel	

Note) Grease is used on rubber and sliding sections.

Flow Rate Characteristics

Note) Values when the main valve is fully open

Male thread nozzle

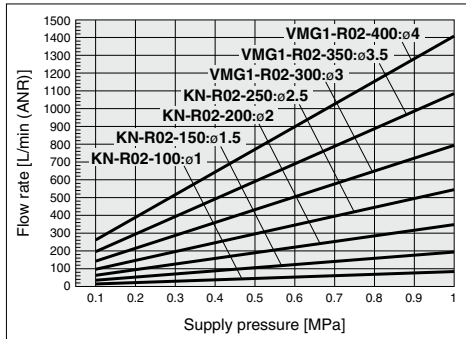

High efficiency nozzle

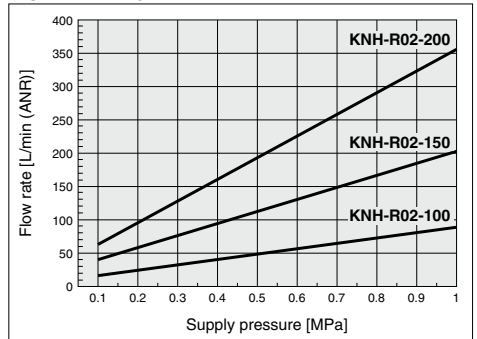

Low noise nozzle with male thread

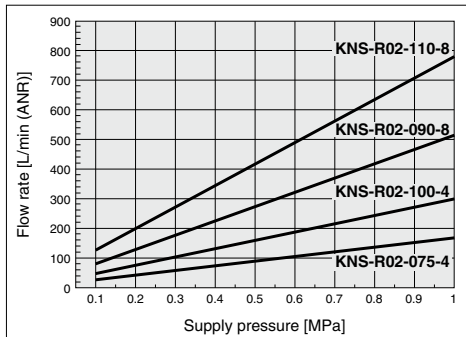

Copper extension nozzle

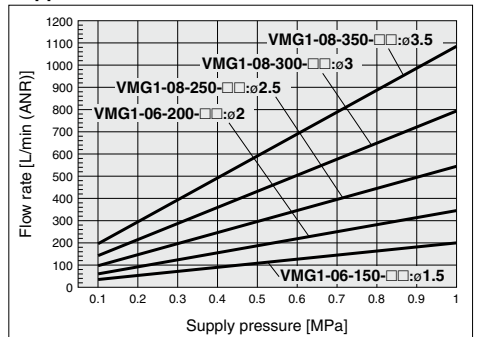

VMG
KN

VMG Series

Dimensions

VMG11/Piping entry: Bottom

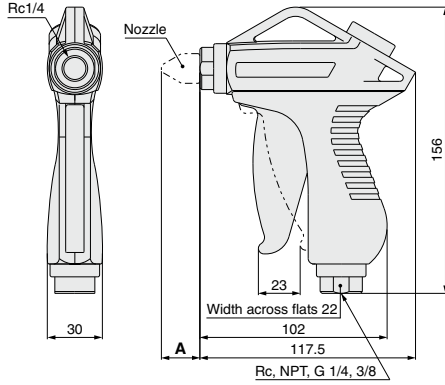

Note) Reference dimensions after installation

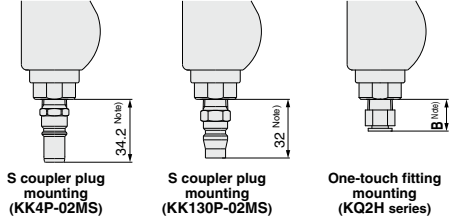

VMG12/Piping entry: Top

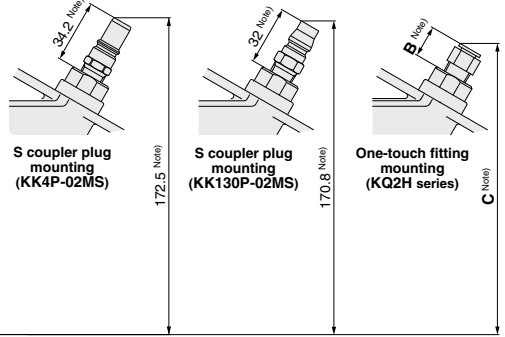
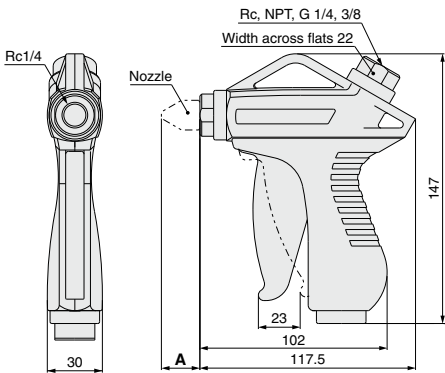

Symbol	Type	Nozzle part no.	Nozzle size	A (Note)
01	Male thread nozzle	KN-R02-100	ø1	23.4
02		KN-R02-150	ø1.5	23
03		KN-R02-200	ø2	22.5
04		KN-R02-250	ø2.5	22.1
05		VMG1-R02-300	ø3	22
06		VMG1-R02-350	ø3.5	21.5
07		VMG1-R02-400	ø4	21.5
11	High efficiency nozzle	KNH-R02-100	ø1	44
12		KNH-R02-150	ø1.5	
13		KNH-R02-200	ø2	
21	Low noise nozzle with male thread	KNS-R02-075-4	ø0.75 x 4	12
22		KNS-R02-090-8	ø0.9 x 8	
23		KNS-R02-100-4	ø1 x 4	
24		KNS-R02-110-8	ø1.1 x 8	
31	ø6 copper extension nozzle (Note)	Nozzle length: VMG1-06-150-300	ø1.5	298
32		Nozzle length: VMG1-06-200-300	ø2	
33		Nozzle length: VMG1-06-150-600	ø1.5	598
34		Nozzle length: VMG1-06-200-600	ø2	
35		Nozzle length: VMG1-06-150-100	ø1.5	98
36		Nozzle length: VMG1-06-200-100	ø2	
37	Nozzle length: VMG1-06-150-150	ø1.5	148	
38	Nozzle length: VMG1-06-200-150	ø2		

Note) Reference dimensions after installation

Symbol	Type	Nozzle part no.	Nozzle size	A (Note)
41	ø8 copper extension nozzle (Note)	VMG1-08-250-100	ø2.5	98
42		Nozzle length: VMG1-08-300-100	ø3	
43		100 mm VMG1-08-350-100	ø3.5	
44		VMG1-08-250-150	ø2.5	
45		Nozzle length: VMG1-08-300-150	ø3	148
46		150 mm VMG1-08-350-150	ø3.5	
47		VMG1-08-250-300	ø2.5	
48		Nozzle length: VMG1-08-300-300	ø3	
49		300 mm VMG1-08-350-300	ø3.5	298
50		VMG1-08-250-600	ø2.5	
51		Nozzle length: VMG1-08-300-600	ø3	
52		600 mm VMG1-08-350-600	ø3.5	

Type	One-touch fitting model	B (Note)	C (Note)
Metric size One-touch fitting	KQ2H06-02AS	12	153.2
	KQ2H08-02AS	17.3	158.6
	KQ2H10-02AS	22.6	163.8
Inch size One-touch fitting	KQ2H07-35AS	12.3	153.2
	KQ2H09-35AS	17.7	158.9
	KQ2H11-35AS	20.7	162

Note) Reference dimensions after installation

Dimensions: Nozzles/KN Series

Male thread nozzle: KN



Part no.	Nozzle size D	Connection thread	Width across flats H ₁	L ₁	A*
KN-R02-100	ø1	R1/4	14	31.4	25.4
KN-R02-150	ø1.5			31	25
KN-R02-200	ø2			30.5	24.5
KN-R02-250	ø2.5			30.1	24.1
VMG1-R02-300	ø3			30	24
VMG1-R02-350	ø3.5			29.5	23.5
VMG1-R02-400	ø4			29.5	23.5

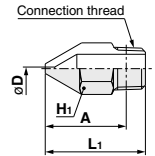

* Reference dimensions after R thread installation

High efficiency nozzle: KNH



Part no.	Nozzle size D	Connection thread	Width across flats H ₁	L ₁	A*
KNH-R02-100	ø1	R1/4	14	52	46
KNH-R02-150	ø1.5				
KNH-R02-200	ø2				

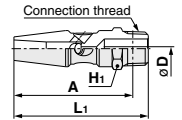

* Reference dimensions after R thread installation

Low noise nozzle with male thread: KNS



Part no.	Nozzle size D	Connection thread	Width across flats H ₁	L ₁	A*
KNS-R02-075-4	ø0.75 x 4	R1/4	14	20	14
KNS-R02-090-8	ø0.9 x 8				
KNS-R02-100-4	ø1 x 4				
KNS-R02-110-8	ø1.1 x 8				

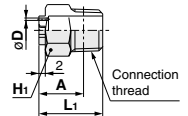

* Reference dimensions after R thread installation

Copper extension nozzle set



Part no.	Nozzle size D	Outside diameter	L ₁	L ₂ (Note1)	L (Note1)	Width across flats H ₁
VMG1-06-150-100	ø1.5	ø6	100	100	106	12
VMG1-06-200-100	ø2		150	150	156	
VMG1-06-150-150	ø1.5		300	300	306	
VMG1-06-200-150	ø2		600	600	606	
VMG1-06-150-300	ø1.5					
VMG1-06-200-300	ø2					
VMG1-08-250-100	ø2.5	ø8	100	100	106	14
VMG1-08-300-100	ø3		150	150	156	
VMG1-08-350-100	ø3.5		300	300	306	
VMG1-08-250-150	ø2.5		600	600	606	
VMG1-08-300-150	ø3					
VMG1-08-350-150	ø3.5					
VMG1-08-250-300	ø2.5					
VMG1-08-300-300	ø3					
VMG1-08-350-300	ø3.5					
VMG1-08-250-600	ø2.5					
VMG1-08-300-600	ø3					
VMG1-08-350-600	ø3.5					

Note 1) Reference dimensions after installation

Note 2) Copper extension nozzle and self-align fitting are included in the same package, (but unassembled). Refer to "How to attach extension nozzle" in the operation manual for assembly procedures.

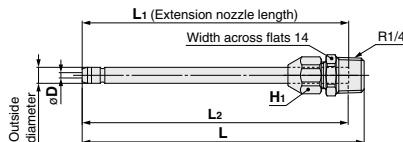

VMG Series

Dimension: Nozzle Cover

Cover for male thread nozzle

(mm)

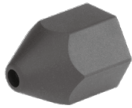

Nozzle cover part no.	Material	Applicable blow gun model	
		Model	Nozzle type
P5670129-01	HNBR	VMG1□□-□-01 to 04	Male thread nozzle ø1 to ø2.5
P5670129-01F	Fluororubber		
P5670129-02	HNBR	VMG1□□-□-05 to 07	Male thread nozzle ø3 to ø4
P5670129-02F	Fluororubber		

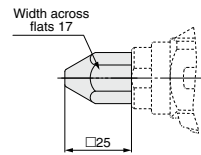

VMG1□-□□-1 to 04

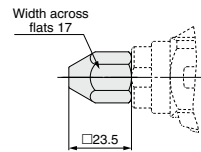

VMG1□-□□-05 to 07

Cover for copper extension nozzle

(mm)



Nozzle cover part no.	Material	Applicable blow gun model	
		Model	Nozzle type
P5670129-11	HNBR	VMG1□□-□-31 to 38	ø6 copper extension nozzle
P5670129-11F	Fluororubber		

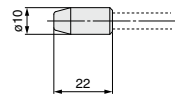

VMG1□-□□-31 to 38