

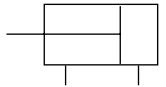

# 低摩擦气缸(薄型) MQQ系列(ø10·ø16·ø20·ø25·ø30·ø40)

图形符号



## 规格

缸径(mm)	10	16	20	25·30	40	
允许 泄漏量 cm <sup>3</sup> /min	供 给 压 力	0.1MPa	150	200	300	400
	0.3MPa	800	1000	1200	1600	
	0.5MPa	1500	2000	3000	4000	
标准行程(mm)	10,20 30,40	10,20,30 40,50,60	10,20,30,40 50,75,100			

## 规格

系列	MQQT	MQQL
密封形式	间隙密封	
动作方式	单杆双作用	
使用流体	空气(不给油)	
使用压力范围(MPa)	0.005~0.5	0.005~0.7
环境及流体温度	-10℃~80℃	
缓冲	垫缓冲(标准品)	
杆端螺纹	内螺纹	
行程长度公差(mm)	+1.0 0	
使用活塞速度(mm/s)	0.3~300	0.5~500

## 型号表示方法

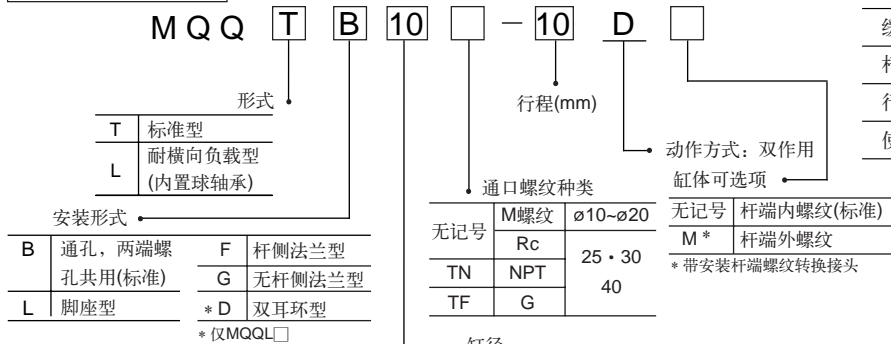

## 安装件

缸径(mm)	脚座	法兰	双耳环	杆端螺纹转换接头(带螺母)
10	CQS-L016	CQS-F016	CQS-D016	MQ10-M
16	CQS-L020	CQS-F020	CQS-D020	MQ16-M
20	CQS-L025	CQS-F025	CQS-D025	MQ20-M
25	MQ-L032	MQ-F032	MQ-D032	MQ25-M
30	MQ-L040	MQ-F040	MQ-D040	MQ28-M
40	CQ-L050	CQ-F050	MQ-D050	MQ28-M

## 外形尺寸图(毫米)

## 标准型

10	10mm	25	25mm
16	16mm	30	30mm
20	20mm	40	40mm

## MQQT B/通孔、两端螺孔 ø10·ø16·ø20

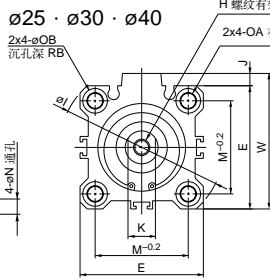
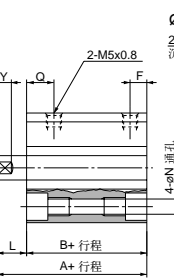
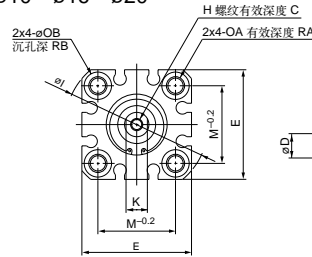

## 杆端外螺纹/MQQ□-□DM

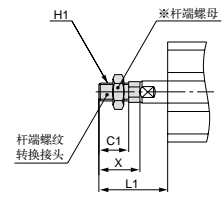
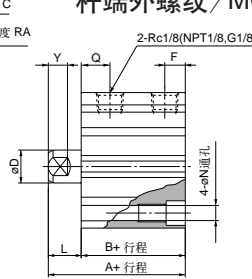

缸径	A	B	C	D	E	F	H	I	J	K	L	M	N	OA	OB	Q	RA	RB	W	Y	L1	C1	H1	X
10	39.5	31.5	6	6	29	5.5	M3 x 0.5	38		5	8	20	3.5	M4 x 0.7	6.5	14.5	7	4		5	23.5	10.5	M5 x 0.8	15.5
16	44	34	8	8	36	5.5	M4 x 0.7	47		7	10	25.5	5.4	M6 x 1.0	9	18	10	7		5	26.5	11.5	M6 x 1.0	16.5
20	47.5	37.5	10	10	40	5.5	M5 x 0.8	52		8	10	28	5.4	M6 x 1.0	9	19.5	10	7		6	28.5	13.5	M8 x 1.25	18.5
25	54	42	12	12	45	8.5	M6 x 1.0	60	4.5	10	12	34	5.5	M6 x 1.0	9	23	10	7	49.5	7	34.5	16.5	M10 x 1.25	22.5
30	60.5	48.5	13	16	52	8.5	M8 x 1.25	69	5	14	12	40	5.5	M6 x 1.0	9	26	10	7	57	10	40.5	22.5	M14 x 1.5	28.5
40	62	50	13	16	64	12	M8 x 1.25	86	7	14	12	50	6.6	M8 x 1.25	11	26	14	8	71	10	40.5	22.5	M14 x 1.5	28.5

## MQQTL/脚座型 ø10·ø16·ø20

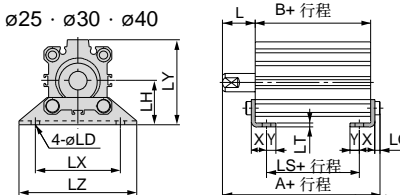
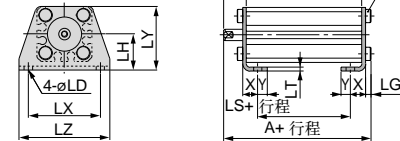

缸径	10	16	20	25	30	40
A	44.3	51.2	54.7	61.2	67.7	70.2
LD	4.5	6.6	6.6	6.6	6.6	9
LG	2.8	4	4	4	4	5
LH	19	24	26	30	33	39
LS	19.5	22	22.5	26	32.5	27
LT	2	3.2	3.2	3.2	3.2	3.2
LX	38	48	52	57	64	79
LY	33.5	42	46	57	64	78
LZ	48	62	66	71	78	95
X	8	9.2	10.7	11.2	11.2	14.7
Y	5	5.8	5.8	5.8	7	8

## MQQTF/杆侧法兰型 ø10·ø16·ø20

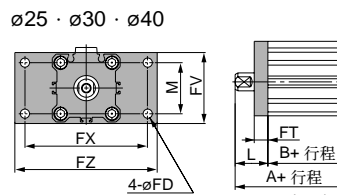
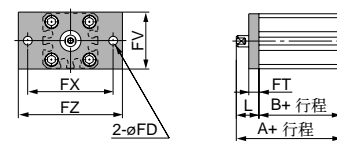

缸径	10	16	20	25	30	40
A	49.5	54	57.5	64	70.5	2
FD	4.5	6.6	6.6	5.5	5.5	6.6
FT	5.5	8	8	8	8	9
FV	30	39	42	48	54	67
FX	45	48	52	56	62	76
FZ	55	60	64	65	72	89
L	18	20	20	22	22	22
M	-	-	-	34	40	50

## MQQTG/无杆侧法兰型 ø10·ø16·ø20

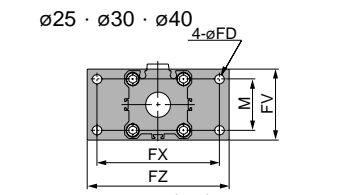
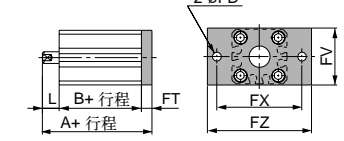

缸径	A	L
10	45	8
16	52	10
20	55.5	10
25	62	12
30	68.5	12
40	70	12

注) 未注尺寸参见左表及上表

# 低摩擦气缸(薄型): MQQ系列

## 外形尺寸图 (毫米)

### 耐横向负载型

MQQLB/通孔、两端螺孔  
 $\phi 10 \cdot \phi 16 \cdot \phi 20$

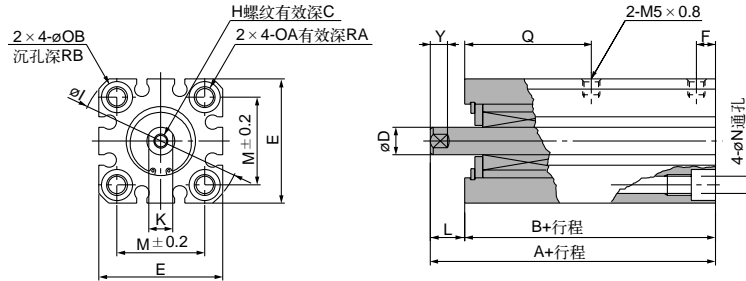

$\phi 25 \cdot \phi 30 \cdot \phi 40$

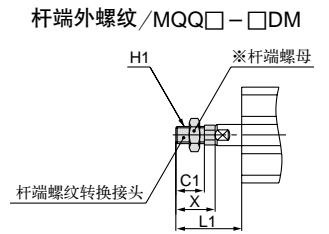
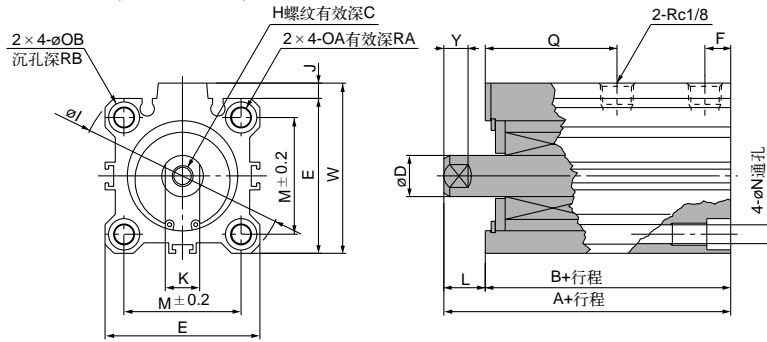

缸径 (mm)	A	B	C	D	E	F	H	I	J	K	L	M	N	OA	OB	Q	RA	RB	W	Y	L1	C1	H1	X
10	69.5	61.5	6	6	29	9	M3×0.5	38	—	5	8	20	3.5	M4×0.7	6.5	39.5	7	4	—	5	23.5	10.5	M5×0.8	15.5
16	80.5	70.5	8	8	36	11.5	M4×0.7	47	—	7	10	25.5	5.4	M6×1.0	9	48.5	10	7	—	5	26.5	11.5	M6×1.0	16.5
20	89	79	10	10	40	12	M5×0.8	52	—	8	10	28	5.4	M6×1.0	9	55	10	7	—	6	28.5	13.5	M8×1.25	18.5
25	96.5	84.5	12	12	45	13.5	M6×1.0	60	4.5	10	12	34	5.5	M6×1.0	9	58	10	7	49.5	7	34.5	16.5	M10×1.25	22.5
30	116	104	13	16	52	17.5	M8×1.25	69	5	14	12	40	5.5	M6×1.0	9	71	10	7	57	10	40.5	22.5	M14×1.5	28.5
40	116	104	13	16	64	17.5	M8×1.25	86	7	14	12	50	6.6	M8×1.25	11	71	14	8	71	10	40.5	22.5	M14×1.5	28.5

MQQLL/脚座型  
 $\phi 10 \cdot \phi 16 \cdot \phi 20$

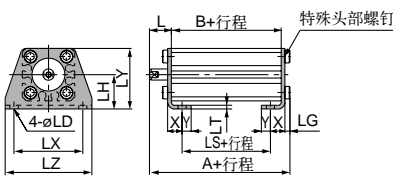

$\phi 25 \cdot \phi 30 \cdot \phi 40$

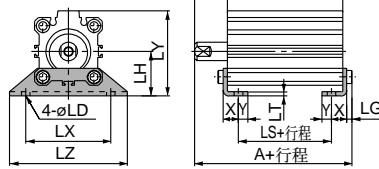

缸径 (mm)	A	LD	LG	LH	LS	LT	LX	LY	LZ	X	Y
10	74.3	4.5	2.8	19	49.5	2	38	33.5	48	8	5
16	87.7	6.6	4	24	58.5	3.2	48	42	62	9.2	5.8
20	96.2	6.6	4	26	64	3.2	52	46	66	10.7	5.8
25	103.7	6.6	4	30	68.5	3.2	57	57	71	11.2	5.8
30	123.2	6.6	4	33	88	3.2	64	64	78	11.2	7
40	124.2	9	5	39	81	3.2	79	78	95	14.7	8

MQQLF/杆侧法兰型  
 $\phi 10 \cdot \phi 16 \cdot \phi 20$

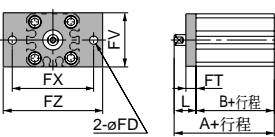

$\phi 25 \cdot \phi 30 \cdot \phi 40$

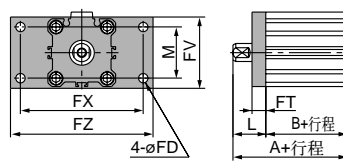

缸径 (mm)	A	B	FD	FT	FV	FX	FZ	L	M
10	79.5	61.5	4.5	5.5	30	45	55	18	—
16	90.5	70.5	6.6	8	39	48	60	20	—
20	99	79	6.6	8	42	52	64	20	—
25	106.5	84.5	5.5	8	48	56	65	22	34
30	126	104	5.5	8	54	62	72	22	40
40	126	104	6.6	9	67	76	89	22	50

MQQLG/无杆侧法兰型  
 $\phi 10 \cdot \phi 16 \cdot \phi 20$

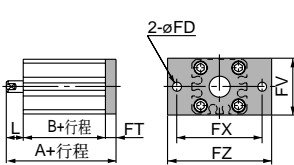

$\phi 25 \cdot \phi 30 \cdot \phi 40$

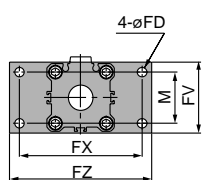

缸径 (mm)	A	L
10	75	8
16	88.5	10
20	97	10
25	104.5	12
30 - 40	124	12

\* 未注尺寸参见杆侧法兰型。

MQQLD/双耳环型

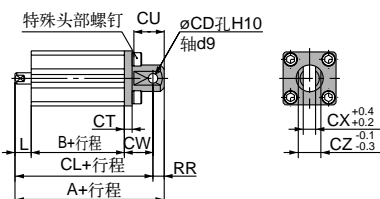

缸径 (mm)	A	B	CD	CL	CT	CU	CW	CX	CZ	L	RR
10	90.5	61.5	5	84.5	4	10	15	6.5	12	8	6
16	107.5	70.5	8	98.5	5	12	18	8	16	10	9
20	119	79	10	109	5	14	20	10	20	10	10
25	126.5	84.5	10	116.5	5	14	20	18	36	12	10
30	148	104	10	138	6	14	22	18	36	12	10
40	158	104	14	144	7	20	28	22	44	12	14