

插管—螺紋類

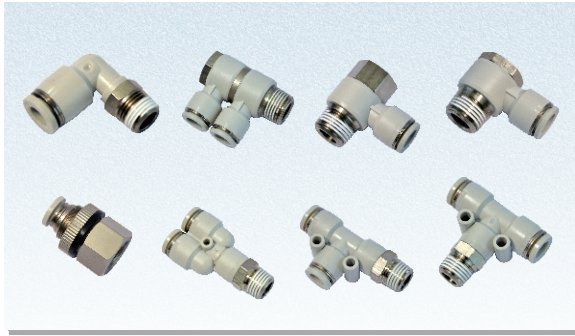

產品特性

- 1、具有多種型號規格，廣泛應用於各類氣動系統；
- 2、流通性能優越，可通過與氣管內徑同容量之流量；
- 3、拔插接管簡單方便又快捷，與氣管連接部份安全可靠又耐用；
- 4、螺紋部分塗有密封劑，M5公制螺紋附密封墊片，確保螺紋連接部份無洩漏；
- 5、鍍銀的銅體可以防腐蝕和污染，應用範圍更寬廣。

訂購碼

PL 6 01 □ □

規格代號	牙型代號
PL: L型螺紋二通	空白: PT牙
PLL: L型加長螺紋二通	T: NPT牙
PLF: L型內螺紋二通	G: G牙
PCF: 內螺紋直通	
PMF: 內牙穿板直通	
PH: 外六角肘節	
PHW: F型螺紋可旋三通	
PHF: 串聯肘節	
PEB: T型正螺紋三通	
PED: T型側螺紋三通	
PYB: Y型螺紋三通	

顏色代號	顏色定義
空白: 灰色	PCF/PMF 接口: 灰色
	其它 接口: 灰色
	其它 本體: 灰色
D: 黑色	PCF/PMF 接口: 黑色
	其它 接口: 黑色
	其它 本體: 黑色

連接螺紋	適用接管口徑
M5: M5×0.8	Φ4\Φ6
01: PT1/8	Φ4\Φ6
02: PT1/4	Φ8\Φ10
03: PT3/8	Φ12
04: PT1/2	

接管口徑
4: Φ4mm
6: Φ6mm
8: Φ8mm
10: Φ10mm
12: Φ12mm

規格

使用壓力範圍	0~9kgf/cm ² (0~0.9MPa)
負壓	-750mmHg(10Torr)
保證耐壓力	1.5MPa
使用溫度範圍(°C)	0~60
適用軟管	尼龍軟管或PU管
顏色	灰色/黑色

接口端螺紋與插管端內徑配置表

產品系列	螺紋規格	插管口徑				
		Φ4	Φ6	Φ8	Φ10	Φ12
PL	M5	●	●			
	PT1/8	●	●	●	●	●
	PT1/4	●	●	●	●	●
	PT3/8		●	●	●	●
PLL	M5	●	●			
	PT1/8	●	●	●	●	
	PT1/4	●	●	●	●	●
	PT3/8		●	●	●	●
PLF	M5	●	●			
	PT1/8	●	●	●	●	
	PT1/4	●	●	●	●	●
	PT3/8		●	●	●	●
PCF	M5	●	●			
	PT1/8	●	●	●	●	
	PT1/4	●	●	●	●	●
	PT3/8		●	●	●	●
PMF	M5	●	●			
	PT1/8	●	●	●	●	
	PT1/4	●	●	●	●	●
	PT3/8		●	●	●	●
PH	M5	●	●			
	PT1/8	●	●	●	●	
	PT1/4		●	●	●	
	PT3/8		●	●	●	●
PHW	M5	●	●			
	PT1/8	●	●	●	●	
	PT1/4		●	●	●	
	PT3/8		●	●	●	●
PHF	M5	●	●			
	PT1/8	●	●	●	●	
	PT1/4		●	●	●	
	PT3/8		●	●	●	●
PEB	M5	●	●			
	PT1/8	●	●	●	●	
	PT1/4	●	●	●	●	●
	PT3/8		●	●	●	●
PED	M5	●	●			
	PT1/8	●	●	●	●	
	PT1/4	●	●	●	●	●
	PT3/8		●	●	●	●
PYB	M5	●	●			
	PT1/8	●	●	●	●	
	PT1/4	●	●	●	●	●
	PT3/8		●	●	●	●

內部結構

型號: PL

序號	名稱	材質
1	塑膠接口	POM
2	定位環	鋁合金
3	彈簧墊片	不銹鋼
4	定位座	POM
5	異型O令	NBR
6	本體	PBT
7	O形環	NBR
8	轉換接頭	黃銅

插管—螺紋類

外部規格

PL系列

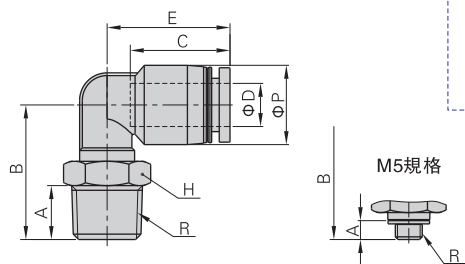

型號符號	ΦD	R	ΦP	A	B	C	E	H	重量(g)
PL4M5	4	M5×0.8	9	3.5	14.8	14	16.8	8	3.1
PL401		PT1/8	9	7.5	18.3	14	16.8	10	4.7
PL402		PT1/4	9	10	21.8	14	16.8	14	11.9
PL6M5	6	M5×0.8	12.5	3.5	17.0	16.9	20.2	8	4.4
PL601		PT1/8	12.5	7.5	20.5	16.9	20.2	10	6.1
PL602		PT1/4	12.5	10	24.0	16.9	20.2	14	13.3
PL603		PT3/8	12.5	11	25.5	16.9	20.2	17	20.6
PL604	PT1/2	12.5	14	30.0	16.9	20.2	21	35.9	
PL801	8	PT1/8	14.7	7.5	20.5	18.6	22.8	10	7.7
PL802		PT1/4	14.7	10	25.0	18.6	22.8	14	13.0
PL803		PT3/8	14.7	11	26.5	18.6	22.8	17	21.2
PL804		PT1/2	14.7	14	31	18.6	22.8	21	36.1
PL1001	10	PT1/8	17.7	7.5	24.9	20.9	25.7	17	16.6
PL1002		PT1/4	17.7	10	26.9	20.9	25.7	17	19.1
PL1003		PT3/8	17.7	11	27.9	20.9	25.7	17	20.8
PL1004		PT1/2	17.7	14	32.4	20.9	25.7	21	37.2
PL1201	12	PT1/8	21	7.5	26.5	22.7	28.5	17	18.9
PL1202		PT1/4	21	10	28.5	22.7	28.5	17	21.5
PL1203		PT3/8	21	11	33	22.7	29.5	17	25.5
PL1204		PT1/2	21	14	34	22.7	29.5	21	37.1

PLL系列

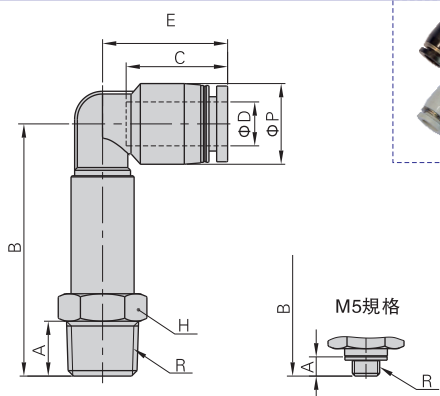

型號符號	ΦD	R	ΦP	A	B	C	E	H
PLL4M5	4	M5×0.8	9	3.5	32.6	14	16.8	8
PLL401		PT1/8	9	7.5	35.9	14	16.8	10
PLL402		PT1/4	9	10	38.9	14	16.8	14
PLL6M5	6	M5×0.8	12.5	3.5	34.8	16.9	20.2	8
PLL601		PT1/8	12.5	7.5	38.1	16.9	20.2	10
PLL602		PT1/4	12.5	10	41.1	16.9	20.2	14
PLL603		PT3/8	12.5	11	43.5	16.9	20.2	17
PLL801	8	PT1/8	14.7	7.5	43.5	18.6	22.8	10
PLL802		PT1/4	14.7	10	46.0	18.6	22.8	14
PLL803		PT3/8	14.7	11	48.5	18.6	22.8	17
PLL1001		PT1/8	17.7	7.5	51.7	20.9	25.7	15
PLL1002	10	PT1/4	17.7	10	54.7	20.9	25.7	15
PLL1003		PT3/8	17.7	11	55.4	20.9	25.7	17
PLL1004		PT1/2	17.7	14	59.9	20.9	25.7	21
PLL1202		PT1/4	21	10	56.3	22.7	28.5	15
PLL1203	12	PT3/8	21	11	61	22.7	29.5	17
PLL1204		PT1/2	21	14	64	22.7	29.5	21

PLF系列

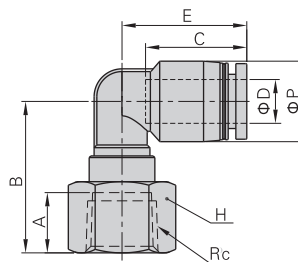

型號符號	ΦD	Rc	ΦP	A	B	C	E	H
PLF4M5	4	M5×0.8	9	6	16.1	14	16.8	10
PLF401		PT1/8	9	8	20.9	14	16.8	14
PLF402		PT1/4	9	11	23.9	14	16.8	17
PLF6M5	6	M5×0.8	12.5	6	18.3	16.9	20.2	10
PLF601		PT1/8	12.5	8	23.1	16.9	20.2	14
PLF602		PT1/4	12.5	11	26.1	16.9	20.2	17
PLF603		PT3/8	12.5	12	27.1	16.9	20.2	21
PLF801	8	PT1/8	14.7	8	20.2	18.6	22.8	14
PLF802		PT1/4	14.7	11	27.7	18.6	22.8	17
PLF803		PT3/8	14.7	12	28.7	18.6	22.8	21
PLF804		PT1/2	14.7	13.5	30.2	18.6	22.8	25
PLF1001	10	PT1/8	17.7	8	24.1	20.9	25.7	17
PLF1002		PT1/4	17.7	11	26.7	20.9	25.7	17
PLF1003		PT3/8	17.7	12	30.1	20.9	25.7	21
PLF1004		PT1/2	17.7	13.5	31.6	20.9	25.7	25
PLF1202	12	PT1/4	21	11	28.3	22.7	28.5	17
PLF1203		PT3/8	21	12	32.2	22.7	29.5	21
PLF1204		PT1/2	21	13.5	33.2	22.7	29.5	25

PCF系列

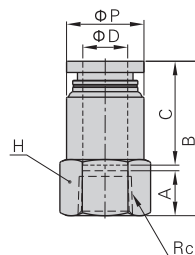

型號符號	ΦD	Rc	ΦP	A	B	C	H
PCF4M5	4	M5×0.8	8.8	6	21	14	10
PCF401		PT1/8	9.5	8	23	14	14
PCF402		PT1/4	9.5	11	26	14	17
PCF6M5	6	M5×0.8	11.8	6	21.5	16.5	12
PCF601		PT1/8	12.5	8	25.5	16.5	14
PCF602		PT1/4	12.5	11	28.5	16.5	17
PCF603		PT3/8	13	12	29.5	16.5	21
PCF604	PT1/2	13	13.5	31.0	16.5	25	
PCF801	8	PT1/8	13.8	8	27.5	18.5	14
PCF802		PT1/4	14.5	11	30.5	18.5	17
PCF803		PT3/8	14.5	12	31.5	18.5	21
PCF804		PT1/2	14.5	13.5	33	18.5	25
PCF1001	10	PT1/8	16.8	8	28.9	20.9	17
PCF1002		PT1/4	16.8	11	32.9	20.9	17
PCF1003		PT3/8	18	12	33.9	20.9	21
PCF1004		PT1/2	18	13.5	35.4	20.9	25
PCF1202	12	PT1/4	20.8	11	33.7	22.7	21
PCF1203		PT3/8	20.8	12	35.7	22.7	21
PCF1204		PT1/2	20.8	13.5	37.2	22.7	25

插管—螺紋類

PH系列

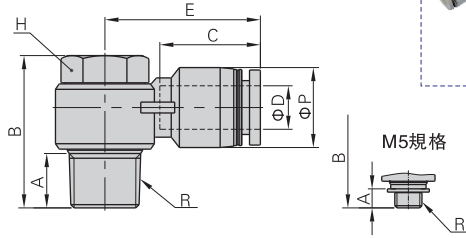

型號符號	ΦD	R	ΦP	A	B	C	E	H
PH4M5	4	M5×0.8	9	3.5	17.1	14	18.9	8
PH401		PT1/8	9	7.5	24.8	14	20.6	11
PH6M5	6	M5×0.8	12.5	3.5	17.1	16.5	23.7	8
PH601		PT1/8	12.5	7.5	24.8	16.5	23.1	11
PH602		PT1/4	12.5	10	28	16.5	25.0	14
PH603	6	PT3/8	12.5	11	33.2	16.5	27.2	19
PH801		PT1/8	14.7	7.5	24.8	18.6	26.7	11
PH802	8	PT1/4	14.7	10	28	18.6	28.6	14
PH803		PT3/8	14.7	11	33.2	18.6	29.4	19
PH804	8	PT1/2	14.7	14	38.9	18.6	31.8	24
PH1002		PT1/4	17.7	10	28	20.7	31	14
PH1003	10	PT3/8	17.7	11	33.2	20.9	33.1	19
PH1004		PT1/2	17.7	14	38.9	20.9	35.5	24
PH1203	12	PT3/8	21	11	33.2	22.7	36.1	19
PH1204		PT1/2	21	14	38.9	22.7	37.8	24

PHW系列

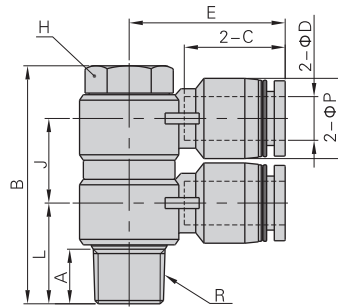

型號符號	ΦD	R	ΦP	A	B	C	E	L	J	H
PHW401	4	PT1/8	9	7.5	38.1	14	20.6	14.6	13.2	11
PHW601		PT1/8	12.5	7.5	38.1	16.5	23.1	15.2	13.2	11
PHW602	6	PT1/4	12.5	10	43.6	16.5	25.0	17.4	15.5	14
PHW603		PT3/8	12.5	11	49.9	16.5	27.2	19.8	16.6	19
PHW801	8	PT1/8	14.7	7.5	40.3	18.6	26.7	16.3	15.4	11
PHW802		PT1/4	14.7	10	43.6	18.6	28.6	18.5	15.5	14
PHW803	8	PT3/8	14.7	11	49.9	18.6	29.4	19.8	16.6	19
PHW804		PT1/2	14.7	14	60.8	18.6	31.8	24.4	21.8	24
PHW1002	10	PT1/4	17.7	10	46.6	20.7	31	20.0	18.5	14
PHW1003		PT3/8	17.7	11	55.1	20.9	33.1	21.2	21.8	19
PHW1004	10	PT1/2	17.7	14	60.8	20.9	35.5	25.0	21.8	24
PHW1203		PT3/8	21	11	55.1	22.7	36.1	22.8	21.8	19
PHW1204	12	PT1/2	21	14	60.8	22.7	37.8	26.4	21.8	24

PHF系列

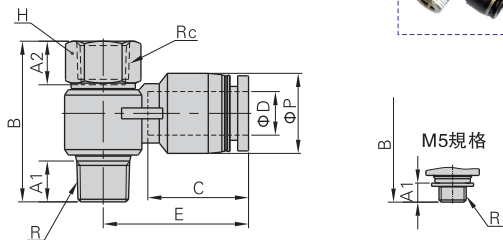

型號符號	ΦD	R	Rc	ΦP	A1	A2	B	C	E	H
PHF4M5	4	M5×0.8	M5×0.8	9	3.5	6	20	14	18.9	8
PHF401		PT1/8	PT1/8	9	7.5	8	29.5	14	20.6	12
PHF6M5	6	M5×0.8	M5×0.8	12.5	3.5	6	20	16.5	23.7	8
PHF601		PT1/8	PT1/8	12.5	7.5	8	29.5	16.5	23.1	12
PHF602		PT1/4	PT1/4	12.5	10	11	34.9	16.5	25.0	17
PHF603	6	PT3/8	PT3/8	12.5	11	12	40	16.5	27.2	19
PHF801		PT1/8	PT1/8	14.7	7.5	8	29.5	18.6	26.7	12
PHF802	8	PT1/4	PT1/4	14.7	10	11	34.9	18.6	28.6	17
PHF803		PT3/8	PT3/8	14.7	11	12	40	18.6	29.4	19
PHF804	8	PT1/2	PT1/2	14.7	14	13.5	47.4	18.6	31.8	24
PHF1002		PT1/4	PT1/4	17.7	10	11	34.9	20.7	31	17
PHF1003	10	PT3/8	PT3/8	17.7	11	12	40	20.9	33.1	19
PHF1004		PT1/2	PT1/2	17.7	14	13.5	47.4	20.9	35.5	24
PHF1203	12	PT3/8	PT3/8	21	11	12	40	22.7	36.1	19
PHF1204		PT1/2	PT1/2	21	14	13.5	47.4	22.7	37.8	24

PEB系列

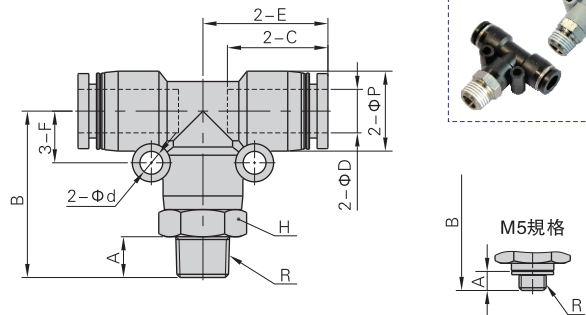

型號符號	ΦD	R	ΦP	Φd	A	B	C	E	F	H
PEB4M5	4	M5×0.8	9	3.2	3.5	21	14	16.8	6.5	9
PEB401		PT1/8	9	3.2	7.5	25	14	16.8	6.5	10
PEB402	4	PT1/4	9	3.2	10	28	14	16.8	6.5	14
PEB6M5		M5×0.8	12.5	3.2	3.5	23.5	16.5	19.9	8	12
PEB601	6	PT1/8	12.5	3.2	7.5	27.5	16.5	19.9	8	12
PEB602		PT1/4	12.5	3.2	10	30.5	16.5	19.9	8	14
PEB603		PT3/8	12.5	3.2	11	32	16.5	19.9	8	17
PEB801	8	PT1/8	14.7	4.3	7.5	30.6	18.6	23	9.5	14
PEB802		PT1/4	14.7	4.3	10	33.1	18.6	23	9.5	14
PEB803	8	PT3/8	14.7	4.3	11	34.6	18.6	23	9.5	17
PEB804		PT1/2	14.7	4.3	14	38.6	18.6	23	9.5	21
PEB1001	10	PT1/8	17.7	4.3	7.5	34.2	20.9	26.3	11	17
PEB1002		PT1/4	17.7	4.3	10	36.7	20.9	26.3	11	17
PEB1003		PT3/8	17.7	4.3	11	37.7	20.9	26.3	11	17
PEB1004	10	PT1/2	17.7	4.3	14	41.7	20.9	26.3	11	21
PEB1202		12	PT1/4	21	4.3	10	41	22.7	29.8	13
PEB1203	PT3/8		21	4.3	11	42	22.7	29.8	13	21
PEB1204	PT1/2		21	4.3	14	45	22.7	29.8	13	21

插管—螺紋類

PYB系列

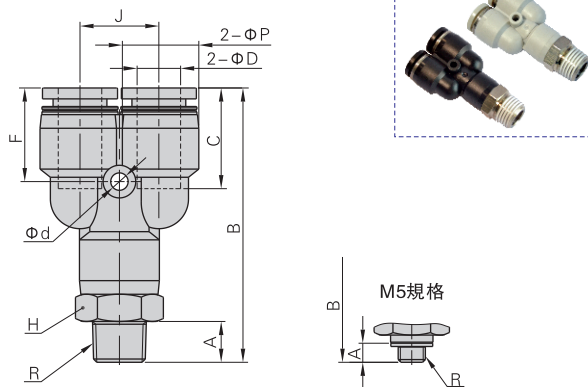

型號符號	ΦD	R	ΦP	Φd	A	B	C	F	J	H
PYB4M5	4	M5×0.8	9	3.2	3.5	35.3	14	12.8	10	9
PYB401		PT1/8	9	3.2	7.5	39.3	14	12.8	10	10
PYB402		PT1/4	9	3.2	10	42.3	14	12.8	10	14
PYB6M5	6	M5×0.8	12.5	3.2	3.5	40.5	16.5	15.5	12	12
PYB601		PT1/8	12.5	3.2	7.5	44.5	16.5	15.5	12	12
PYB602		PT1/4	12.5	3.2	10	47.5	16.5	15.5	12	14
PYB603	8	PT3/8	12.5	3.2	11	49.0	16.5	15.5	12	17
PYB801		PT1/8	14.7	3.2	7.5	50.2	18.6	17	14.5	14
PYB802		PT1/4	14.7	3.2	10	52.7	18.6	17	14.5	14
PYB803	8	PT3/8	14.7	3.2	11	54.2	18.6	17	14.5	17
PYB804		PT1/2	14.7	3.2	14	58.2	18.6	17	14.5	21
PYB1001		PT1/8	17.7	4.3	7.5	56.6	20.9	19.3	18	17
PYB1002	10	PT1/4	17.7	4.3	10	59.1	20.9	19.3	18	17
PYB1003		PT3/8	17.7	4.3	11	60.1	20.9	19.3	18	17
PYB1004		PT1/2	17.7	4.3	14	64.1	20.9	19.3	18	21
PYB1202	12	PT1/4	21	4.3	10	65.8	22.7	21	20.5	21
PYB1203		PT3/8	21	4.3	11	66.8	22.7	21	20.5	21
PYB1204		PT1/2	21	4.3	14	69.8	22.7	21	20.5	21

PED系列

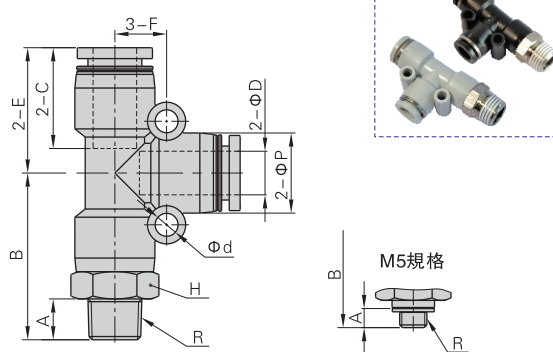

型號符號	ΦD	R	ΦP	Φd	A	B	C	E	F	H
PED4M5	4	M5×0.8	9	3.2	3.5	21	14	16.8	6.5	9
PED401		PT1/8	9	3.2	7.5	25	14	16.8	6.5	10
PED402		PT1/4	9	3.2	10	28	14	16.8	6.5	14
PED6M5	6	M5×0.8	12.5	3.2	3.5	23.5	16.5	19.9	8	12
PED601		PT1/8	12.5	3.2	7.5	27.5	16.5	19.9	8	12
PED602		PT1/4	12.5	3.2	10	30.5	16.5	19.9	8	14
PED603	8	PT3/8	12.5	3.2	11	32	16.5	19.9	8	17
PED801		PT1/8	14.7	4.3	7.5	30.6	18.6	23	9.5	14
PED802		PT1/4	14.7	4.3	10	33.1	18.6	23	9.5	14
PED803	8	PT3/8	14.7	4.3	11	34.6	18.6	23	9.5	17
PED804		PT1/2	14.7	4.3	14	38.6	18.6	23	9.5	21
PED1001		PT1/8	17.7	4.3	7.5	34.2	20.9	26.3	11	17
PED1002	10	PT1/4	17.7	4.3	10	36.7	20.9	26.3	11	17
PED1003		PT3/8	17.7	4.3	11	37.7	20.9	26.3	11	17
PED1004		PT1/2	17.7	4.3	14	41.7	20.9	26.3	11	21
PED1202	12	PT1/4	21	4.3	10	41	22.7	29.8	13	21
PED1203		PT3/8	21	4.3	11	42	22.7	29.8	13	21
PED1204		PT1/2	21	4.3	14	45	22.7	29.8	13	21

PMF系列

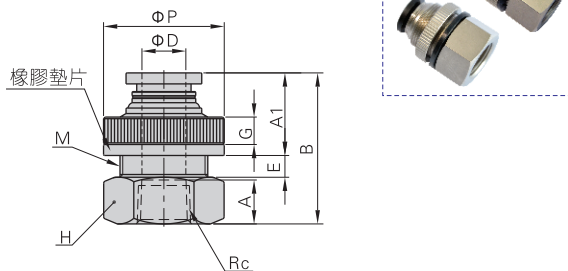

型號符號	ΦD	Rc	ΦP	A	A1	B	E	G	M	H
PMF401	4	PT1/8	16	8	11.9	25	4.1	4	M12×1	14
PMF402		PT1/4	16	11	11.9	29	4.1	4	M12×1	17
PMF601	6	PT1/8	19	8	12.5	25.5	5	4	M14×1	17
PMF602		PT1/4	19	11	12.5	30.5	5	4	M14×1	17
PMF603	8	PT3/8	19	12	12.5	31.5	5	4	M14×1	21
PMF801		PT1/8	22	8	14.4	27.5	4.6	5	M16×1	19
PMF802		PT1/4	22	11	14.4	32	4.6	5	M16×1	19
PMF803	8	PT3/8	22	12	14.4	33	4.6	5	M16×1	21
PMF804		PT1/2	22	13.5	14.4	34.5	4.6	5	M16×1	25
PMF1001		PT1/8	26	8	14.4	29.9	7.5	5	M20×1	22
PMF1002	10	PT1/4	26	11	14.4	34.9	7.5	5	M20×1	22
PMF1003		PT3/8	26	12	14.4	35.9	7.5	5	M20×1	22
PMF1004	12	PT1/2	26	13.5	14.4	37.4	7.5	5	M20×1	25
PMF1202		PT1/4	28	11	15.5	34.7	8.2	6	M22×1	24
PMF1203		PT3/8	28	12	15.5	37.7	8.2	6	M22×1	24
PMF1204	12	PT1/2	28	13.5	15.5	39.2	8.2	6	M22×1	25