

浮動接頭



浮動接頭與氣缸配套表

氣缸系列	SE						SI/SIL									
附件名稱	32	40	50	63	80	100	125	32	40	50	63	80	100	125	160	200
F-M10X125F	●							●								
F-M12X125F		●							●							
F-M16X150F			●	●						●	●					
F-M20X150F					●	●						●	●			

氣缸系列	SG/SGC			SC/SCL/SU/SUL				JSI									
附件名稱	125	160	200	250	32	40	50	63	80	100	32	40	50	63	80	100	125
F-M10X125F					●						●						
F-M12X125F						●							●				
F-M14X150F														●			
F-M16X150F							●	●							●	●	
F-M18X150F														●	●		
F-M20X150F										●	●						

氣缸系列	ACP						ACQ														
附件名稱	12	16	20	25	32	40	50	63	80	100	12	16	20	25	32	40	50	63	80	100	
F-M8X125F		●												●							
F-M10X125F			●	●	●	●									●						
F-M12X125F							●	●													
F-M14X150F																	●	●			
F-M16X150F									●												
F-M18X150F																		●	●		
F-M20X150F										●											

氣缸系列	MA				MAL				MF						
附件名稱	16	20	25	32	40	50	63	20	25	32	40	20	25	32	40
F-M6X100F	●														
F-M8X125F		●						●				●			
F-M10X125F			●	●					●	●			●	●	
F-M12X125F					●					●					
F-M14X150F						●	●								●

氣缸系列	PB				MI								
附件名稱	4	6	10	12	16	8	10	12	16	20	25	32	40
F-M3X050F		●											
F-M4X070F			●			●	●						
F-M5X080F				●	●								
F-M6X100F							●	●					
F-M8X125F									●				
F-M10X125F										●	●		
F-M12X125F												●	

外部規格

M6及以下規格

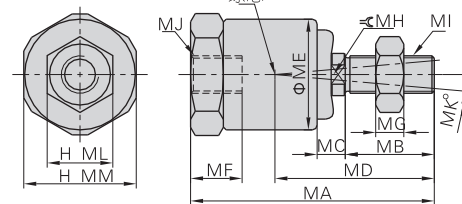

型號符號	MA	MB	MC	MD	ME	MF	MG	MH	MI	MJ	ML	MM	角度補償	徑向補償
F-M3X050F	23.5	7.5	3	15	11.8	5.5	2.4	4	M3×0.5	5.5	12		±5°	0.5
F-M4X070F	26	9.5	3	17	11.8	6	3	4	M4×0.7	7	12		±5°	0.5
F-M5X080F	34.5	13.5	3.5	22.8	13.8	8	4	6	M5×0.8	8	14		±5°	0.5
F-M6X100F	34.5	13.5	3.5	22.8	13.8	8	4	6	M6×1.0	10	14		±5°	0.5

M8及以上規格

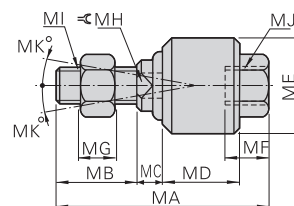

型號符號	MA	MB	MC	MD	ME	MF	MG	MH	MI	MJ	MK
F-M8X125F	51	20	6	17	24	10.5	6	8	M8×1.25	M8×1.25	13
F-M10X125F	58	22	7	21	26	11	6	10	M10×1.25	M10×1.25	12
F-M12X125F	58	22	8	21	28	11.5	7	12	M12×1.25	M12×1.25	12
F-M14X150F	70	22.5	8.5	28	34.5	16	8	15	M14×1.5	M14×1.5	12
F-M16X150F	90	27	10	41	44.5	19	8	17	M16×1.5	M16×1.5	7
F-M18X150F	92	27	10	41	44.5	21	11	18	M18×1.5	M18×1.5	7
F-M20X150F	102	29	13	46	53	22	10	22	M20×1.5	M20×1.5	10

成品訂購碼

F-M10X125 F

附件編號

附件類別

F: 浮動接頭

螺紋規格

M3: M3
M4: M4
M5: M5
M6: M6
M8: M8
M10: M10
M12: M12
M14: M14
M16: M16
M18: M18
M20: M20

螺紋牙距

螺紋規格	螺紋牙距
M3	050: 0.5mm
M4	070: 0.7mm
M5	080: 0.8mm
M6	100: 1.0mm
M8/M10/M12	125: 1.25mm
M14/M16	150: 1.5mm
M18/M20	



浮動接頭